

FORM B - BUILDING

MASSACHUSETTS HISTORICAL COMMISSION
Office of the Secretary, State House, Boston

In Area no.	Form no.
	398-115



Northampton
 Address 152 South Street
 Name "Locke House" (Mrs. George Strong House)
 Present use Residence
 Present owner Charles H. Foley
 Construction date: 1887
Daily Hampshire Gazette
November 22, 1887
 Style Queen Anne

4. Map. Draw sketch of building location in relation to nearest cross streets and other buildings. Indicate north.

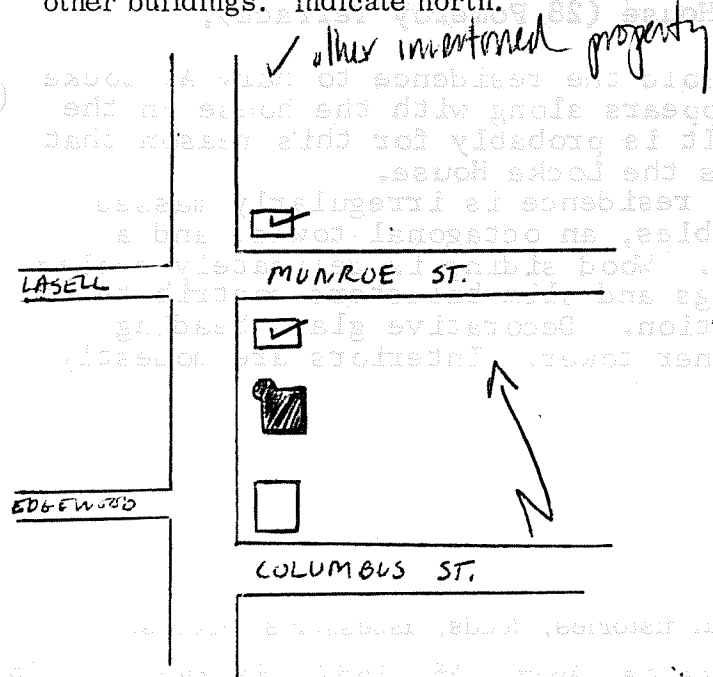

Architect C. H. Jones
 Exterior wall fabric wood shingles
 Outbuildings (describe) _____
 Other features octagonal tower; central gable; balcony with fine balustrade; sunburst motif in porch gable
 Altered no Date _____
 Moved no Date _____

5. Lot size:
 One acre or less x Over one acre _____
 Approximate frontage 120 feet
 Approximate distance of building from street 50 feet

DO NOT WRITE IN THIS SPACE
 USGS Quadrant _____
 MHC Photo no. _____

6. Recorded by C, Dubie
 Organization Northampton Historical Commission
 Date June 10, 1975

RECEIVED
 FEB 6 1976
 MASS. HIST. COMM.

7. Original owner (if known) Mrs. George Strong

Original use _____ Residence _____

Subsequent uses (if any) and dates _____ Residence _____

8. Themes (check as many as applicable)

Aboriginal	_____	Conservation	_____	Recreation	_____
Agricultural	_____	Education	_____	Religion	_____
Architectural	_____	Exploration/	_____	Science/	_____
The Arts	<u>x</u>	settlement	_____	invention	_____
Commerce	_____	Industry	_____	Social/	_____
Communication	_____	Military	_____	humanitarian	_____
Community development	_____	Political	_____	Transportation	_____

9. Historical significance (include explanation of themes checked above)

C. H. Jones, local architect. 1875, Gazette notes that "C. H. Jones of this town, the well-known painter, is acquiring quite a reputation as an architect." A schoolhouse and hotel were at that time attributed to him; by 1887, the year of the design of the Strong (Locke) house, Jones had planned 57 houses, 3 churches, and other buildings. "His first house was the house of Wm. A. Dickinson, Hatfield." Other residences in Northampton designed by Jones include the Crooks House (28 Pomeroy Terrace),

Mrs. George (Martha) Strong sold the residence to Mary A. Locke in 1895 and the Locke name appears along with the house on the 1895 Atlas of Northampton. It is probably for this reason that the house is locally known as the Locke House.

Three stories in height, the residence is irregularly massed and incorporates numerous gables, an octagonal tower, and a turretted second story porch. Wood siding is delicately scaled and scalloped; porch railings and slim balusters contribute to the lightness of the composition. Decorative glass beading appears in panels on the corner tower. Interiors are modestly executed.

10. Bibliography and/or references (such as local histories, deeds, assessor's records, early maps, etc.)

Daily Hampshire Gazette, April 26, 1887, November 11, 1887.
 Registry of Deeds, Hampshire County, 475.5, 410.434.
 Atlas of Northampton, 1895.