

FORM B - BUILDING

In Area no.	Form no.
	39A-67

MASSACHUSETTS HISTORICAL COMMISSION  
Office of the Secretary, State House, Boston



1 Northampton

ess off Hampton Terrace

2 "The Beeches"

ent use Residential

ent owner Colburn & Sidney Bailey  
(for sale)

ription:

1914-15

ource Daily Hampshire Gazette  
4/1/1930

Tudor Revival

4. Map. Draw sketch of building location in relation to nearest cross streets and other buildings. Indicate north.

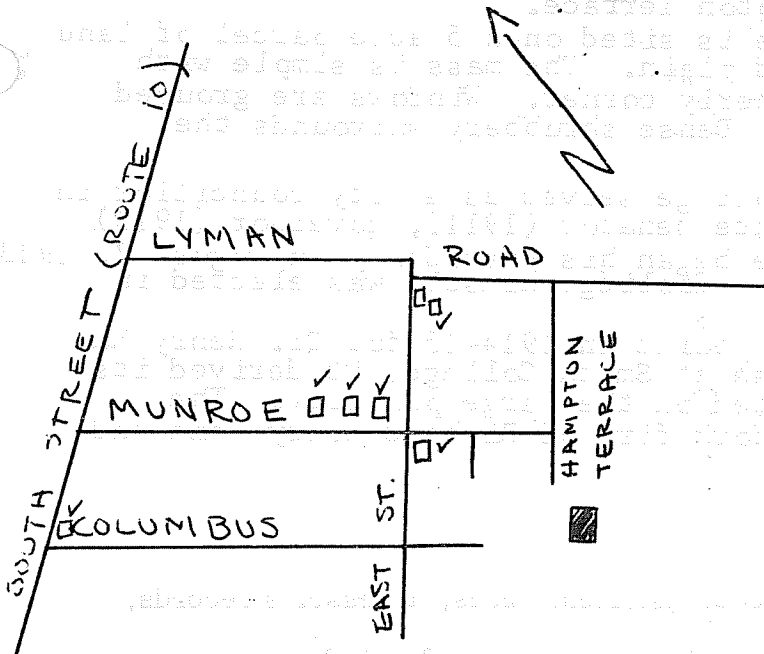

Architect Murphy & Dana of N. Y.

Exterior wall fabric wood shingles

Outbuildings (describe) none

Other features steep tiled roofs;  
shingled wall surfaces; bays,  
massive chimneys.

Altered no Date \_\_\_\_\_

Moved no Date \_\_\_\_\_

5. Lot size:

Less than one acre x Over one acre \_\_\_\_\_

Approximate frontage \_\_\_\_\_

Approximate distance of building from street \_\_\_\_\_

✓ - INVENTORIED PROPERTY

DO NOT WRITE IN THIS SPACE
USGS Quadrant _____
MHC Photo no. _____

6. Recorded by C. Dubie

Organization Northampton Historical  
Commission

Date May 15, 1976

RECEIVED

(over)

JUN 30 1976

7. Original owner (if known) Dr. Henry N. MacCracken 1095

Original use Residence

Subsequent uses (if any) and dates Residence

8. Themes (check as many as applicable)

Aboriginal	_____	Conservation	_____	Recreation	_____
Agricultural	_____	Education	_____	Religion	_____
Architectural	<u>x</u>	Exploration/ settlement	_____	Science/ invention	_____
The Arts	_____	Industry	_____	Social/	_____
Commerce	_____	Military	_____	Humanitarian	_____
Communication	_____	Political	<u>x</u>	Transportation	_____
Community development	_____				

9. Historical Significance (include explanation of themes checked above)

The Beeches was the home of Calvin Coolidge following his presidency. The Coolidge family lived there from 1930 to 1937, at which time Mrs. Coolidge moved to Washington Street. The former president had died in 1933.

Coolidge began his legal career in Northampton in 1897 and at that period boarded with various families on Round Hill and King Street. In 1907 Coolidge began to rent a dwelling on Massasoit Street; the family remained there through 1930, two years after Coolidge's presidency, when the steady stream of sightseers prompted the move to more secluded Hampton Terrace.

The three story residence is sited on a 5 acre parcel of land and overlooks the Ox Bow flood plain. The mass is simple with a deeply gabled L at the southerly corner. Windows are grouped and divided into small panes. Dense shrubbery surrounds the dwelling.

Between 1899 and 1928 Coolidge served as a city councillor in Northampton, mayor (1909), state senator (1911), governor (1918) and vice-president (1920). He began his Presidency on August 2, 1923, when Warren G. Harding died. Coolidge himself was elected in 1924.

The 16 room residence was built in 1914-15 for Dr. Henry MacCracken, a professor of English at Smith College; it derived its name from eighty beeches planted on the large property. The home was designed by the New York firm of Richard Henry Dana and Henry K. Murphy.

10. Bibliography and/or references (such as local histories, deeds, assessor's records, early maps, etc.)

Northampton City Directory, 1930-1940;  
Daily Hampshire Gazette Index, Forbes Library  
Gazette, 4/1/1930; 4/3/1930.