

MASSACHUSETTS HISTORICAL COMMISSION  
Office of the Secretary, State House, Boston

In Area no.	Form no.
	22B-18



City Northampton

Address 53 Corticelli St.

Present use residence

Present owner \_\_\_\_\_

Description: \_\_\_\_\_

Source 1860-73 Map and Atlas

Architect \_\_\_\_\_

4. Map. Draw sketch of building in relation to nearest cross streets and other buildings. Indicate north.

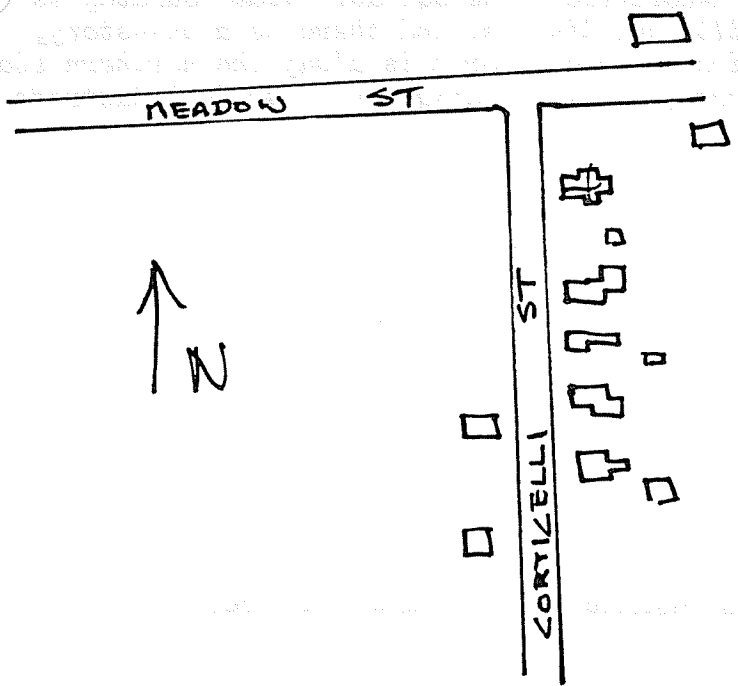

Exterior wall fabric clapboard

Outbuildings (describe) \_\_\_\_\_

Other features decorative shingles in gable, barge boards and wide boarding; one-story bay window on facade.

Altered -- Date \_\_\_\_\_

Moved -- Date \_\_\_\_\_

5. Lot size: One acre or less \_\_\_\_\_ Over one acre \_\_\_\_\_

Approximate frontage \_\_\_\_\_

Approximate distance of building from street \_\_\_\_\_

6. Recorded by E. Lonergan

Organization NHC

Date June 1980

(over)

7. Original owner (if known) \_\_\_\_\_

Original use residence

Subsequent uses (if any) and dates \_\_\_\_\_

8. Themes (check as many as applicable)

Aboriginal	_____	Conservation	_____	Recreation	_____
Agricultural	_____	Education	_____	Religion	_____
Architectural	<u>x</u>	Exploration/ settlement	_____	Science/ invention	_____
The Arts	_____	Industry	_____	Social/ humanitarian	_____
Commerce	_____	Military	_____	Transportation	_____
Communication	_____	Political	_____		
Community development	<u>x</u>				

9. Historical significance (include explanation of themes checked above)

*Prospect St. was laid out around 1860 atop the western terrace of the Mill River just above the three water privileges that Florence developed around. The "prospect" is a fine view of the Florence meadows, extending westerly and northerly. The first owner of this house was James Robertson, a foreman at the Florence Sewing Machine Co.*

*This is a T-shaped house with one-and-a-half story gabled ends. The gables all have fish-scale shingles and decorative barge boards. Wide boarding is used as bettcourses connecting the window sills and lintels, and there is a one-story, three-sided bay window on the front projection. A small porch is along the northern side of this front projection, and has square posts, arched openings and a solid balustrade.*

10. Bibliography and/or references (such as local histories, deeds, assessor's records, early maps, etc.)

- 1850 County Map.*
- 1873, 1884 and 1895 Atlases.*
- Northampton Directory: 1890-91, 1888-89, 1875-76.*
- Registry of Deeds: Bk. 133-P. 339 and 399, 202-89 and 90.*