

FORM B - BUILDING

MASSACHUSETTS HISTORICAL COMMISSION
Office of the Secretary, State House, Boston

In Area no.	Form no. 16 23A- 16
-------------	--------------------------------------

163



Town Northampton

Address 14 Park Street

Name A. Estabrook House

Present use residence

Present owner Justin & Ellen Stone

Description:

Year 1884

Source Reg. of Deeds & Atlas

Reference Bracketed

Architect _____

in relation to nearest cross streets and other buildings. Indicate north.

Exterior wall fabric clapboard

Outbuildings (describe) _____

Other features _____

Altered --- Date _____

Moved --- Date _____

5. Lot size:

One acre or less _____ Over one acre _____

Approximate frontage _____

Approximate distance of building from street _____

6. Recorded by E. Lonergan

Organization NHC

Date February 1980

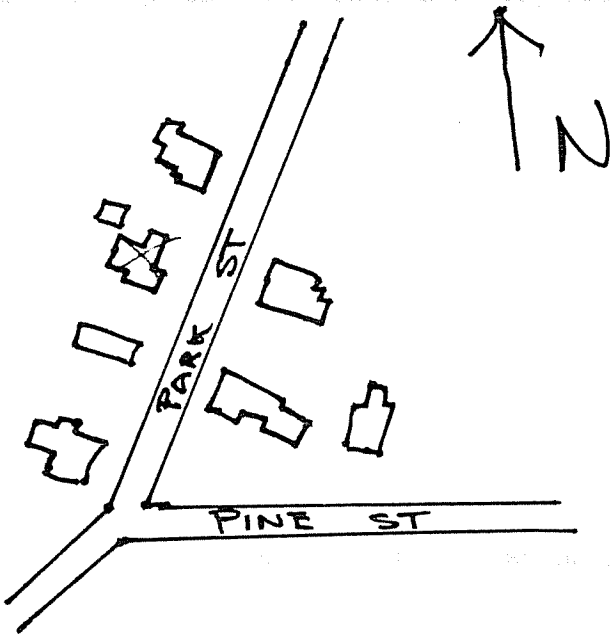

(over)

7. Original owner (if known) Alanson C. Estabrook

Original use residence

Subsequent uses (if any) and dates _____

8. Themes (check as many as applicable)

- | | | | | | |
|-----------------------|----------|----------------------------|-------|-------------------------|-------|
| Aboriginal | _____ | Conservation | _____ | Recreation | _____ |
| Agricultural | _____ | Education | _____ | Religion | _____ |
| Architectural | <u>x</u> | Exploration/
settlement | _____ | Science/
invention | _____ |
| The Arts | _____ | Industry | _____ | Social/
humanitarian | _____ |
| Commerce | _____ | Military | _____ | Transportation | _____ |
| Communication | _____ | Political | _____ | | |
| Community development | _____ | | | | |

9. Historical significance (include explanation of themes checked above)

In 1884 Alanson Estabrook bought the northern part of Amos Eldredge's Park St. homestead for \$850. As the 1884 atlas shows Mr. Estabrook's house, it must have been built during that year. Mr. Estabrook was superintendent of the Florence Manufacturing Co.

The house is two-and-a-half stories tall, L-shaped and features an assortment of brackets in its decorative trim. Cut-out brackets are used on a frieze and under the raking cornices of the roof gables, while brackets with pendants adorn the chamfered posts of the front porch, and small modillions support the slightly-arched window lintels. A two-story bay window projects from the southern side of the house.

10. Bibliography and/or references (such as local histories, deeds, assessor's records, early maps, etc.)

- 1873, 1884 & 1895 Atlases
- Registry of Deeds: Bk.387-P.325
- Northampton Directory: 1884-85