

FORM B - BUILDING

MASSACHUSETTS HISTORICAL COMMISSION
Office of the Secretary, State House, Boston

175

In Area no.	Form no.
	23A-48



Northampton

Address 26 & 28 West Center Street

Brick House

Present use Residence

Present owner Ralph & Ruth Grandy

Description: c. 1850

Source visual evidence

Style Greek Revival

4. Map. Draw sketch of building location in relation to nearest cross streets and other buildings. Indicate north.

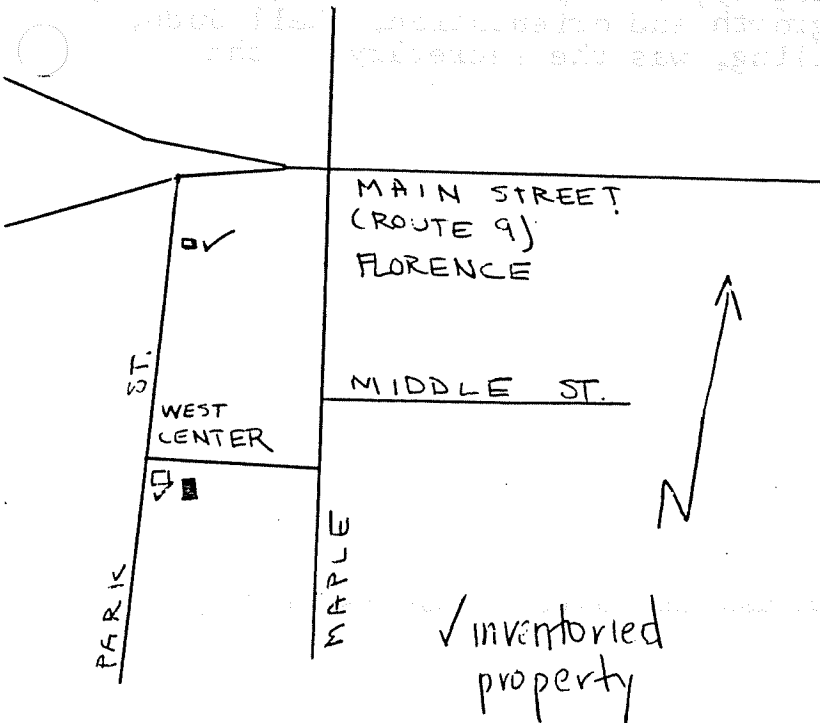

DO NOT WRITE IN THIS SPACE

USGS Quadrant _____

MHC Photo no. _____

Architect unknown

Exterior wall fabric brick

Outbuildings (describe) none

Other features 2 1/2 stories; stone lintels; round-headed window in gable; 2 interior chimneys; additions

Altered additions Date _____

Moved no Date _____

5. Lot size:

Less than one acre x Over one acre _____

Approximate frontage 75 feet

Approximate distance of building from street 40 feet

6. Recorded by C. Dubie

Organization Northampton Historical Commission

Date May 12, 1976

(over)

RECEIVED

JUN 4 1976

7. Original owner (if known) unknown

Original use residence

Subsequent uses (if any) and dates residence

8. Themes (check as many as applicable)

Aboriginal	<u> </u>	Conservation	<u> </u>	Recreation	<u> </u>
Agricultural	<u> </u>	Education	<u> </u>	Religion	<u> </u>
Architectural	<u> x </u>	Exploration/ settlement	<u> </u>	Science/ invention	<u> </u>
The Arts	<u> </u>	Industry	<u> </u>	Social/ Humanitarian	<u> </u>
Commerce	<u> </u>	Military	<u> </u>	Transportation	<u> </u>
Communication	<u> </u>	Political	<u> </u>		
Community development	<u> x </u>				

9. Historical Significance (include explanation of themes checked above)

A well built brick dwelling, this c. 1850 house is located adjacent to the 1846 Hall Judd House and may be the work of the same builder. Treatment of cornice details is similar as are the brick and stone employed. The structure is a two story brick cube with moderately pitched roof and paired chimneys located in the roof ridge. A brick addition at the rear and a wooden addition at the east are also present.

Florence developed in the mid-nineteenth century as a manufacturing center and progressive community. The Northampton Association of Education and Industry, a utopian community (1841-47), was important in the village's growth and orientation. Hall Judd, owner of the adjacent brick dwelling, was the secretary of the Association.

10. Bibliography and/or references (such as local histories, deeds, assessor's records, early maps, etc.)