

FORM B - BUILDING

MASSACHUSETTS HISTORICAL COMMISSION  
Office of the Secretary, State House, Boston

253

In Area no.	Form no.
	23D-50



1 Northampton

Address 89 Riverside Drive

City

Present use residence

Present owner

Description:

Approximate date of construction c. 1910

Source Atlases and Directories

Other sources

Architect

Exterior wall fabric wood shingles

Outbuildings (describe)

Other features

Altered -- Date

Moved -- Date

5. Lot size:

One acre or less  Over one acre

Approximate frontage

Approximate distance of building from street

6. Recorded by E. Lonergan

Organization NHC

Date April 1980

4. Map. Draw sketch of building location in relation to nearest cross streets and other buildings. Indicate north.

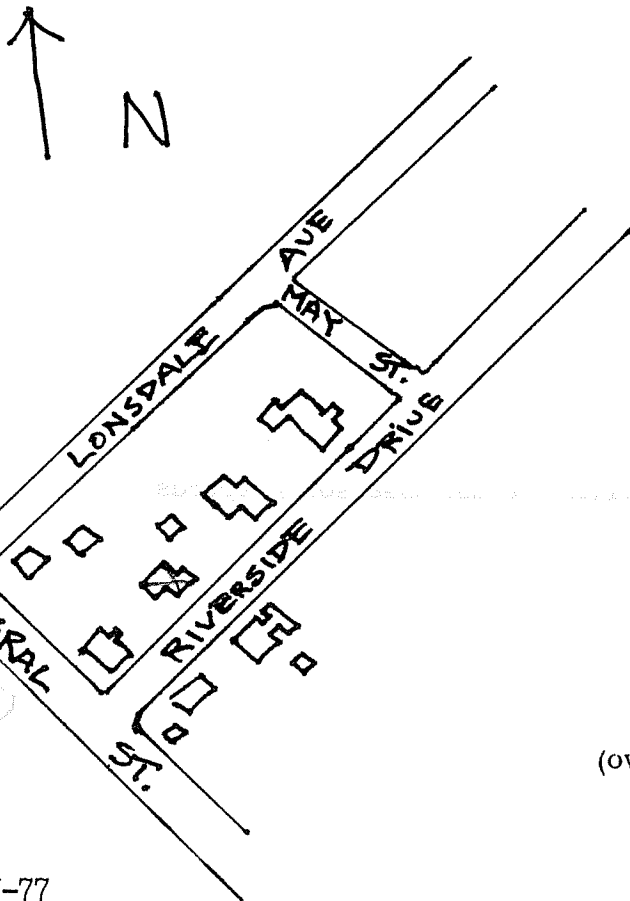

(over)

7. Original owner (if known) \_\_\_\_\_

Original use residence

Subsequent uses (if any) and dates \_\_\_\_\_

8. Themes (check as many as applicable)

- |                       |          |                            |       |                         |       |
|-----------------------|----------|----------------------------|-------|-------------------------|-------|
| Aboriginal            | _____    | Conservation               | _____ | Recreation              | _____ |
| Agricultural          | _____    | Education                  | _____ | Religion                | _____ |
| Architectural         | <u>X</u> | Exploration/<br>settlement | _____ | Science/<br>invention   | _____ |
| The Arts              | _____    | Industry                   | _____ | Social/<br>humanitarian | _____ |
| Commerce              | _____    | Military                   | _____ | Transportation          | _____ |
| Communication         | _____    | Political                  | _____ |                         |       |
| Community development | _____    |                            |       |                         |       |

9. Historical significance (include explanation of themes checked above)

This early 20th century residence is interesting for its complex massing and shingled surface. The porch which extends across the facade and halfway along the western side has broadly arched openings between the shingled posts, and is recessed under the extended gable roof. A bay dormer with polygonal roof is also on the western side.

10. Bibliography and/or references (such as local histories, deeds, assessor's records, early maps, etc.)

Northampton Directory: 1905 and 1915.