

FORM B - BUILDING

MASSACHUSETTS HISTORICAL COMMISSION
Office of the Secretary, State House, Boston

In Area no.	Form no. <u>277</u>
	<u>24C-3</u>



Northampton

SS 291 Prospect Street

nt use residence

nt owner Donald & Mona Sprecker

ription: c. 1840

urce visual evidence

Greek Revival

itect unknown

4. Map. Draw sketch of building location in relation to nearest cross streets and other buildings. Indicate north.

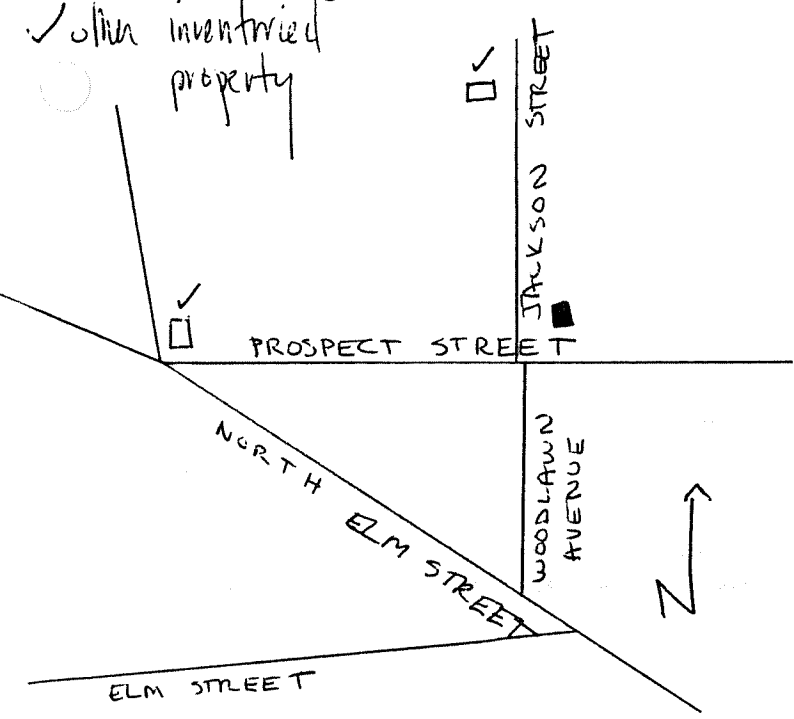

Exterior wall fabric brick

Outbuildings (describe) none

Other features 2 stories; brick with stone lintels; wing, east facade; wooden dormer in roof.

Altered yes Date _____

Moved no Date _____

5. Lot size:

Less than one acre x Over one acre _____

Approximate frontage 130 feet

Approximate distance of building from street 30 feet

6. Recorded by C. Dible

Organization Northampton Historical Commission

Date November 15, 1975

DO NOT WRITE IN THIS SPACE

USGS Quadrant _____

MHC Photo no. _____

(over)

RECEIVED

MAY 5 1976

7. Original owner (if known) unknown (not researched)

Original use residence

Subsequent uses (if any) and dates residence

8. Themes (check as many as applicable)

Aboriginal	<input type="checkbox"/>	Conservation	<input type="checkbox"/>	Recreation	<input type="checkbox"/>
Agricultural	<input type="checkbox"/>	Education	<input type="checkbox"/>	Religion	<input type="checkbox"/>
Architectural	<input checked="" type="checkbox"/>	Exploration/ settlement	<input type="checkbox"/>	Science/ invention	<input type="checkbox"/>
The Arts	<input type="checkbox"/>	Industry	<input type="checkbox"/>	Social/ Humanitarian	<input type="checkbox"/>
Commerce	<input type="checkbox"/>	Military	<input type="checkbox"/>	Transportation	<input type="checkbox"/>
Communication	<input type="checkbox"/>	Political	<input type="checkbox"/>		
Community development	<input type="checkbox"/>				

9. Historical Significance (include explanation of themes checked above)

A well built Greek Revival styledwelling, located on upper Prospect Street about 1/2 way between Northampton center and the village of Florence. The structure is three bays wide, with narrow stone lintels spanning the evenly spaced window openings. An enclosed pediment is broken by a single, perhaps later, window; brick dentils are introduced on theunderside of the cornice. An early addition to the east facade and a more recent shed dormer in the roofline throw the house somewhat off balance. It appears as though one of four original chimneys was sacrificed for the dormer.

10. Bibliography and/or references (such as local histories, deeds, assessor's records, early maps, etc.)