

FORM B - BUILDING

In Area no.	Form no.
	24C-183

MASSACHUSETTS HISTORICAL COMMISSION  
Office of the Secretary, State House, Boston



1 Northampton

Address 204 Crescent St.

Use residence

Present owner Charles and Delores Kulikowski

Description:

Year 1884-95

Source Atlases

Architect \_\_\_\_\_

Exterior wall fabric clapboard and wood shingle

Outbuildings (describe) \_\_\_\_\_

Other features \_\_\_\_\_

Altered -- Date \_\_\_\_\_

Moved -- Date \_\_\_\_\_

5. Lot size:

One acre or less x Over one acre \_\_\_\_\_

Approximate frontage \_\_\_\_\_

Approximate distance of building from street \_\_\_\_\_

6. Recorded by E. Lonergan

Organization NHC

Date March 1980

7. Map. Draw sketch of building and lot in relation to nearest cross streets and other buildings. Indicate north.

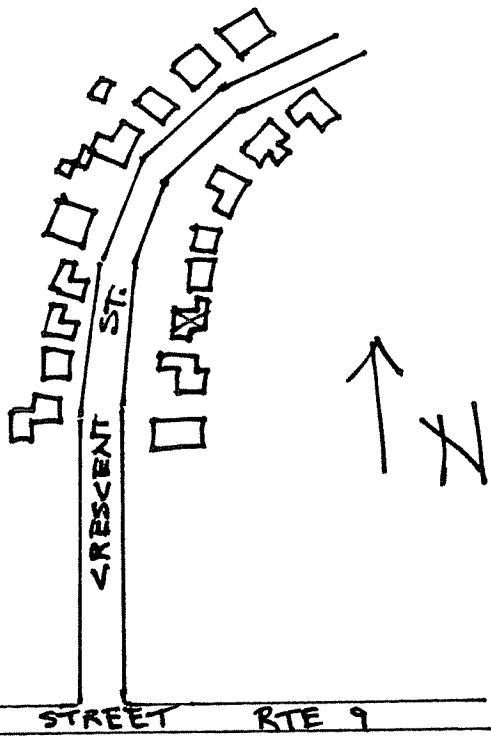

(over)

7. Original owner (if known) \_\_\_\_\_

Original use \_\_\_\_\_ residence \_\_\_\_\_

Subsequent uses (if any) and dates \_\_\_\_\_

8. Themes (check as many as applicable)

Aboriginal	_____	Conservation	_____	Recreation	_____
Agricultural	_____	Education	_____	Religion	_____
Architectural	<u>  x  </u>	Exploration/ settlement	_____	Science/ invention	_____
The Arts	_____	Industry	_____	Social/ humanitarian	_____
Commerce	_____	Military	_____	Transportation	_____
Communication	_____	Political	_____		
Community development	_____				

9. Historical significance (include explanation of themes checked above)

This is one of two virtually identical, late-Victorian houses on Crescent St. built c. 1890. Crescent St. had been laid out in 1886 along the middle slopes of Round Hill, through the estate of the Round Hill Hotel. The 1895 atlas shows this house and lists George Johnson, owner of a Pleasant St. furniture and stove store, as the owner.

The house features several varieties of decoratively-cut shingles, a three-story tower with pyramidal, slate roof and finial, and a front porch with turned posts, fancy brackets and balustrade.

10. Bibliography and/or references (such as local histories, deeds, assessor's records, early maps, etc.)

1884 and 1895 Atlases.

Worhampton Directory: 1895-96.