

MASSACHUSETTS HISTORICAL COMMISSION
Office of the Secretary, State House, Boston

In Area no. E	Form no. 24D-318
------------------	---------------------

361



Location Northampton
Address 95 Round Hill Road
Name Minshall House
Present use Residence

Present owner Clarke School

Description:
1898-99
Source Gazette, 12/17/1898;
Northampton City Directory

Roof Shingle

Architect R. F. Putnam

Exterior wall fabric wood shingles

Outbuildings (describe) none

Other features asymmetrical mass; gable
with half-timbering and leaded-
pane windows; entrance portico

Altered no Date _____

Moved no Date _____

5. Lot size:
Less than one acre x Over one acre _____

Approximate frontage _____

Approximate distance of building from street
_____ 30 feet

6. Recorded by C. Dubie

Organization Northampton Historical
Commission

Date June 7, 1976

4. Map. Draw sketch of building location in relation to nearest cross streets and other buildings. Indicate north.

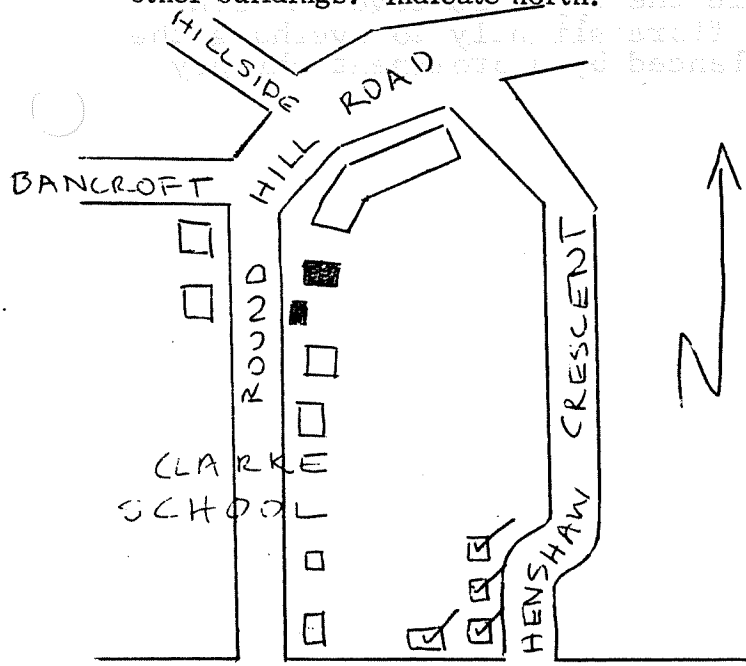

DO NOT WRITE IN THIS SPACE
USGS Quadrant _____
MHC Photo no. _____

(over)

RECEIVED
JUN 30 1976
MASS. HIST. COMM.

7. Original owner (if known) Dr. Minshall

Original use Residence

Subsequent uses (if any) and dates Residence

8. Themes (check as many as applicable)

Aboriginal	_____	Conservation	_____	Recreation	_____
Agricultural	_____	Education	_____	Religion	_____
Architectural	<u>x</u>	Exploration/ settlement	_____	Science/ invention	_____
The Arts	_____	Industry	_____	Social/	_____
Commerce	_____	Military	_____	Humanitarian	_____
Communication	_____	Political	_____	Transportation	_____
Community development	_____				

9. Historical Significance (include explanation of themes checked above)

Roswell F. Putnam, Northampton's leading architect in the later nineteenth century designed this residence for a local physician, Dr. Minshall. The Gazette described the house as "a semi-timbered style with stained clapboards and shingles."

The design is typical of shingle styles which incorporated allusions to the English Queen Anne like the prominent chimneys, diamond pane windows, and timber-framing in the gable and entrance. The lower story is clapboarded while the upper is covered with small rectangular shingles, which flare slightly to overhang the lower story. The main gable is balanced by a prominent chimney and a hooded dormer.

10. Bibliography and/or references (such as local histories, deeds, assessor's records, early maps, etc.)

Hampshire Gazette, 12/17/1898;
 Northampton City Directory, 1898, 1899. Forbes Library.