

FORM B - BUILDING

MASSACHUSETTS HISTORICAL COMMISSION  
Office of the Secretary, State House, Boston

421

In Area no.	Form no.
	30A-32



Northampton (Bay State)

Address Riverside Drive

Northampton

Cutlery Company-factory

Present use factory

Present owner Northampton Cutlery Co,

Description:

1840-1918

Source Deeds, visual evidence, Maps, Atlases

Romaneque  
predominantly Victorian Industrial

Architect unknown-various

Exterior wall fabric brick

Outbuildings (describe) small brick shop

Other features brick factory structures

1-3 stories; stone lintels; Victorian

brickwork; portions of raceway remaining

Altered additions Date \_\_\_\_\_

Moved no Date \_\_\_\_\_

5. Lot size:

One acre or less \_\_\_\_\_ Over one acre x

Approximate frontage 375 feet

Approximate distance of building from street

150 feet

6. Recorded by C. Dubie

Organization Northampton Historical Commission

Date September 15, 1975

RECEIVED

MAY 5 1976

MASS. HIST. COMM.

4. Map. Draw sketch of building in relation to nearest cross streets and other buildings. Indicate north.

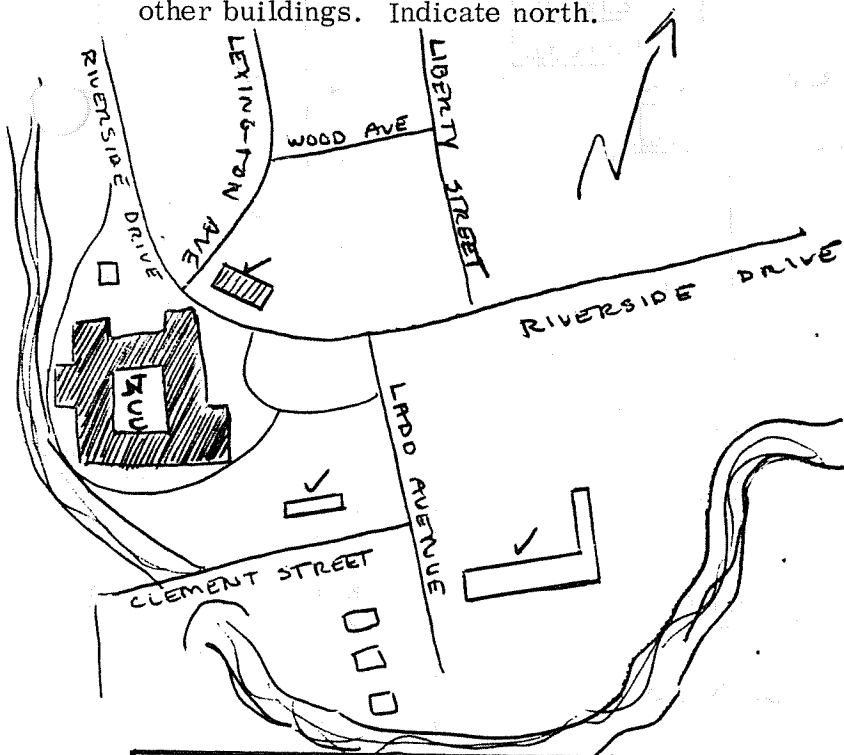

DO NOT WRITE IN THIS SPACE
USGS Quadrant _____
MHC Photo no. _____

*✓ other industrial property*

(over)

WORKERS  
HOUSING

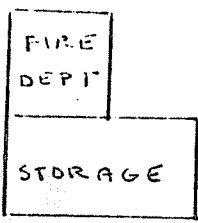
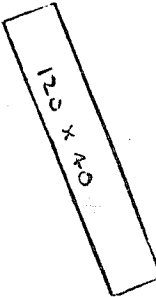

MILL RIVER

RACEWAY

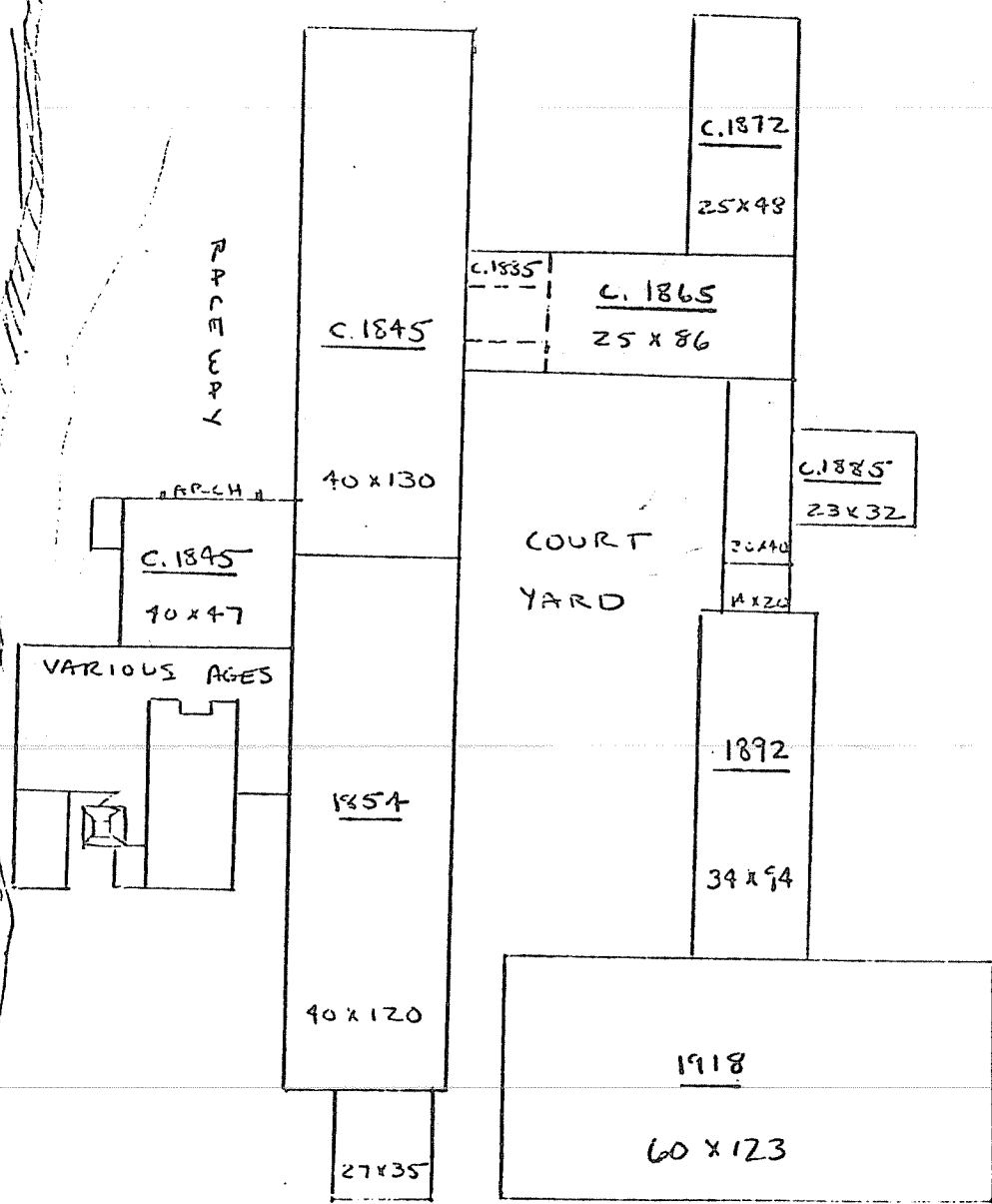

G  
R  
O  
U  
T  
H  
O  
F  
N  
O  
R  
T  
H  
A  
M  
P  
T  
O  
N  
C  
U  
T  
L  
E  
R  
Y

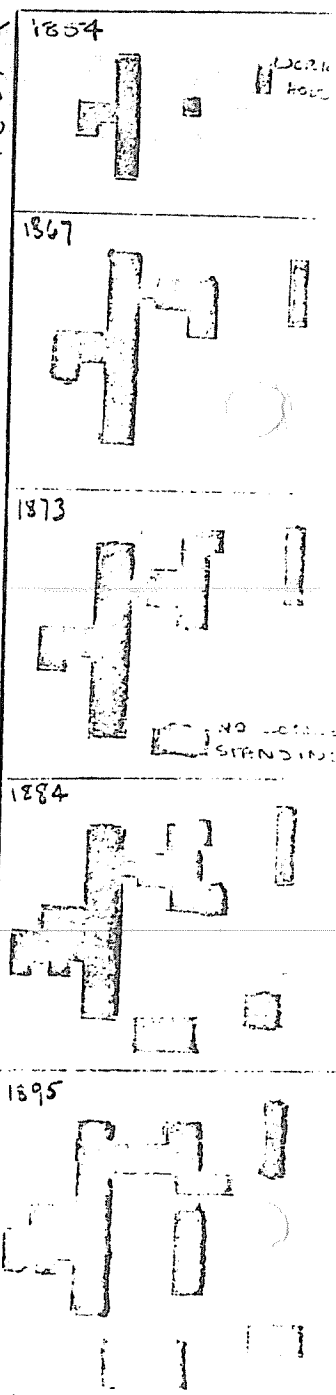

MILL RIVER

PLAN OF NORTHAMPTON  
CUTLERY COMPANY,  
1965

7. Original owner (if known) see below

Original use Manufacturing concern

Subsequent uses (if any) and dates Manufacturing concern

8. Themes (check as many as applicable)

Aboriginal	_____	Conservation	<u>x</u>	Recreation	_____
Agricultural	_____	Education	_____	Religion	_____
Architectural	<u>x</u>	Exploration/ settlement	_____	Science/ invention	_____
The Arts	_____	Industry	<u>x</u>	Social/ humanitarian	_____
Commerce	_____	Military	_____	Transportation	_____
Communication	_____	Political	_____		
Community development	_____				

9. Historical significance (include explanation of themes checked above)

Northampton Cutlery Company, producers of fine quality knife blades, have occupied this industrial site on the Mill River since 1871. Prior to that time, a series of mills were located on the property: Riverside Cutlery Co. (1870), Bay State Hardware Co. (1858-1870), Bay State Tool Manufacturing Co. (1854-1858), Hampshire Flax and Hemp Co. (1848-50), Northampton Paper Mills (1836-1848). The papermills were an extensive concern which in 1848 owned the area adjoining the Mill River which now contains The Cutlery, the former Clement Company, and the former Northampton Paper Company (Not to be confused with Northampton Paper Mills).

Early deeds include stipulations that factories using the mill and its dams not "disturb or discolor" the water in the Mill River; clean water was required by paper concerns located along the river's length and an attempt was made to regulate the activities of upstream concerns.

The present Cutlery consists of a grouping of structures enclosing a rectangular courtyard, and a small brick shop located to the north of the main factory complex. On a hill overlooking the factory is located a brick block of worker's housing erected by one of the earlier manufacturing concerns.

The various buildings comprising the cutlery have been dated by means of several maps and atlases. An 1867 map of the Hardware Company was drawn by E. C. Gardner, then practicing architecture in Florence; it is possible that Gardner designed some of the Cutlery buildings at about this time. See plan attached.

The small brick outbuilding to the north of the factory complex has served as a library, firehouse, and part of the Northampton Community a Fourierite community of the 1840's.

10. Bibliography and/or references (such as local histories, deeds, assessor's records, early maps, etc.)

"Chronicle of Industry on the Mill River," Smith College Studies in History, Volume XXI, Nos. 1-4, p. 22.  
 The Northampton Book, 233-239.  
 Registry of Deeds, Hampshire County, 286.306, 283.317, 276.103, 240.190, 180.422, 174.312-318, 164.370, 155.115, 140.7, 130.109, 129.281.

Deed 240.190 shows a portion of a map of the Bay State Hardware Co. The whole map (1867), drawn by E. C. Gardner, is owned by Northampton Cutlery Company.  
 Daily Hampshire Gazette, 5/30/1854. 4/11/1895. 3/73