

FORM B - BUILDING

Area	Form no.
	30C-49

MASSACHUSETTS HISTORICAL COMMISSION
 294 Washington Street, Boston, MA 02108



Northampton

506 Florence Rd.

ic Name

iginal residence

resent residence

hip: Private individual
Private organization

Public

original owner

OPTION:

Date late 19th century

Source visual evidence

Style

Architect

Exterior wall fabric clapboard

Outbuildings

Major alterations (with dates)

Moved --- Date

Approx. acreage over one acre

Setting

cross streets and other buildings or geographical features.

Indicate north.

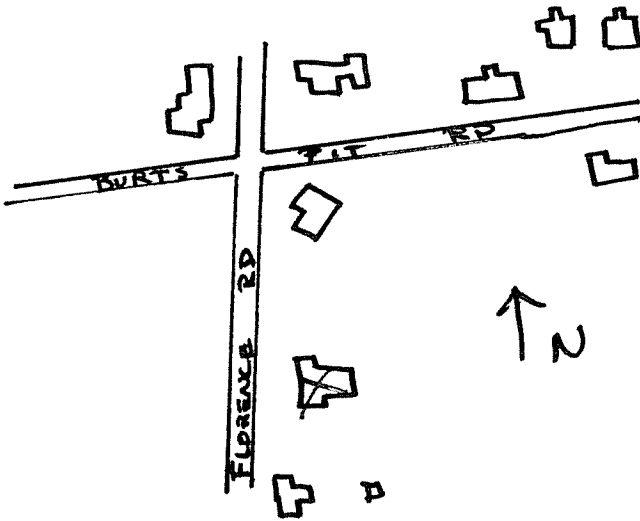

E. Lonergan

Recorded by

Organization NHC

Date June 1980

ARCHITECTURAL SIGNIFICANCE (describe important architectural features and evaluate in terms of other buildings within community)

This late 19th century house is distinguished by its two-story corner tower with tent roof and finial, and a one-story front porch with hipped roof, projecting cornice with frieze and Tuscan columns. The main part of the house is 1½ stories in height, but there is a 2½ story gabled projection on the southern side of the house, which gives the house a complex, original profile.

HISTORICAL SIGNIFICANCE (explain the role owners played in local or state history and how the building relates to the development of the community)

Florence Rd., originally known as South St., first appears on the 1854 Hampshire Co. Map as a connecting route between Florence and Easthampton. The road begins at a junction with West St. (now Ryam Rd.) at the middle crossing of the Mill River at Florence, and heads south to a junction with Easthampton Rd. (now Wilson Rd.) near the Easthampton line. Only a few farms were scattered along this road until the 20th century and more particularly until after the Second World War when suburban development lined this street with houses.

BIBLIOGRAPHY and/or REFERENCES

1831 Town Map.
1854 and 1860 County Maps.
1873, 1884 and 1895 Atlases.