

FORM B - BUILDING

MASSACHUSETTS HISTORICAL COMMISSION
Office of the Secretary, State House, Boston

In Area no.	Form no.
	16B-51



1 Northampton

Address 209 North Main Street

Telephone

Present use

Present owner Lucy Warner

Description:

Year built 1871-72

Source Registry of Deeds

Reference

Architect

in relation to nearest cross streets and other buildings. Indicate north.

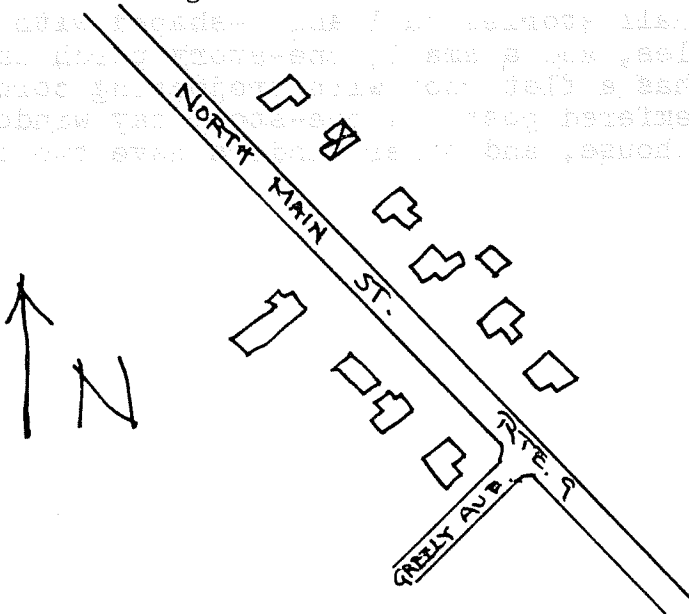

Exterior wall fabric clapboard

Outbuildings (describe)

Other features

Altered Date

Moved Date

5. Lot size:

One acre or less X Over one acre

Approximate frontage 65'

Approximate distance of building from street 30'

DO NOT WRITE IN THIS SPACE

USGS Quadrant

MHC Photo no.

6. Recorded by E. Lonergan

Organization NHC

Date January 1980

(over)

7. Original owner (if known) Daniel E. Barker

Original use residence

Subsequent uses (if any) and dates _____

8. Themes (check as many as applicable)

- | | | | | | |
|-----------------------|----------|----------------------------|-------|-------------------------|-------|
| Aboriginal | _____ | Conservation | _____ | Recreation | _____ |
| Agricultural | _____ | Education | _____ | Religion | _____ |
| Architectural | <u>x</u> | Exploration/
settlement | _____ | Science/
invention | _____ |
| The Arts | _____ | Industry | _____ | Social/
humanitarian | _____ |
| Commerce | _____ | Military | _____ | Transportation | _____ |
| Communication | _____ | Political | _____ | | |
| Community development | <u>x</u> | | | | |

9. Historical significance (include explanation of themes checked above)

In 1871 Daniel Barker bought lot no. 7 of Charles Warren's subdivision plan for the north side of North Main St. in Florence for \$200. The next year he sold the premises to Erastus Munson of Whately for \$1400. The house is shown on the 1873 atlas with Mr. Munson as the owner, but, according to the directories he never lived here.

The house is two-and-a-half stories tall and L-shaped with a small oculus in each of the gables, and a small, one-story porch in the crook of the L. The porch has a flat roof with projecting cornice and is supported by a single chamfered post. A one-story bay window projects from the facade of the house, and other windows have two over two sashes and molded cornices.

10. Bibliography and/or references (such as local histories, deeds, assessor's records, early maps, etc.)

1873, 1894 & 1895 atlases
 Registry of Deeds: Bk. 220-P. 271, 288-250
 Northampton Directory: 1873-74, 1875-76, 1885-86.