

FORM B - BUILDING

| | |
|-------------|-----------|
| In Area no. | Form no. |
| | 31A-251-4 |

MASSACHUSETTS HISTORICAL COMMISSION
Office of the Secretary, State House, Boston



1 Northampton

ress 64 Kensington Avenue

ie _____

sent use residence

sent owner Smith College

ription: _____

e 1890-95

ource Reg. of Deeds & Atlas

le _____

4. Map. Draw sketch of building in relation to nearest cross streets and other buildings. Indicate north.

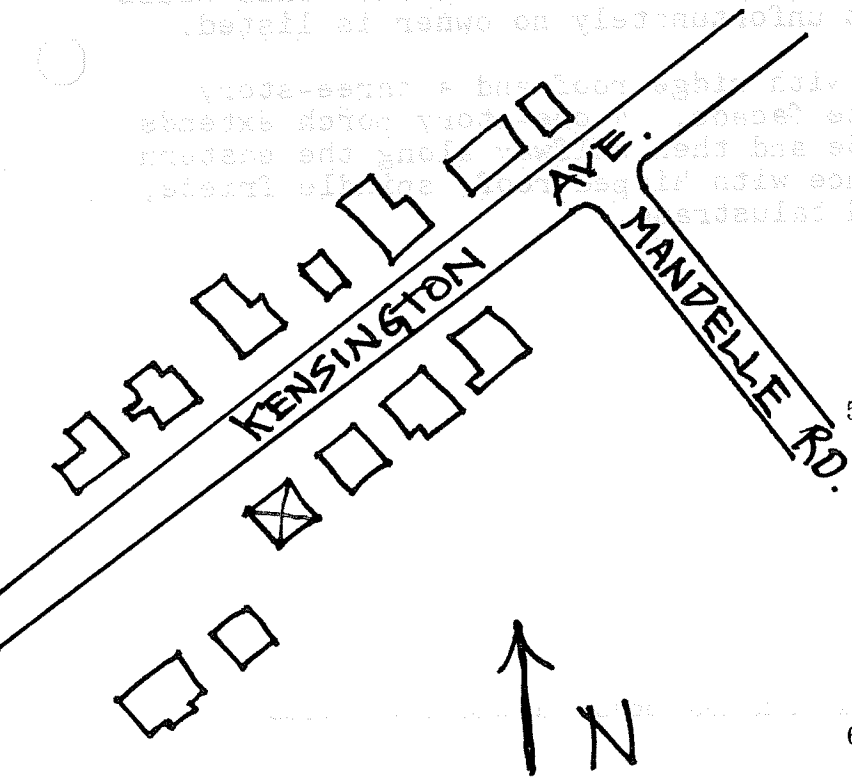

hitect _____

Exterior wall fabric clapboard

Outbuildings (describe) _____

Other features 2-story corner bay with bay dormer, front half porch with turned posts, spindle frieze and balustrade

Altered --- Date _____

Moved --- Date _____

5. Lot size: _____

One acre or less Over one acre _____

Approximate frontage _____

Approximate distance of building from street _____

6. Recorded by E. Lonergan

Organization NHC

Date March 1980

(over)

. Original owner (if known) _____

Original use residence

Subsequent uses (if any) and dates _____

8. Themes (check as many as applicable)

| | | | | | |
|-----------------------|--------------|----------------------------|-------|-------------------------|-------|
| Aboriginal | _____ | Conservation | _____ | Recreation | _____ |
| Agricultural | _____ | Education | _____ | Religion | _____ |
| Architectural | <u> x </u> | Exploration/ settlement | _____ | Science/ invention | _____ |
| The Arts | _____ | Industry | _____ | Social/ humanitarian | _____ |
| Commerce | _____ | Military | _____ | Transportation | _____ |
| Communication | _____ | Political | _____ | | |
| Community development | <u> x </u> | | | | |

9. Historical significance (include explanation of themes checked above)

Kensington Ave. was opened in 1890 through the Elm St. homestead of Aaron Breck. The developer was Charles Crouch, Northampton's most prolific builder of the 19th century. Mr. Crouch built houses on contract or built them for himself, then leasing them out as tenements. This house first appears on the 1895 atlas, but unfortunately no owner is listed.

The house is 2½ stories tall with ridge roof and a three-story bay window with polygonal roof on the facade. A one-story porch extends from the bay window across the facade and then halfway along the eastern side. The porch has a gabled entrance with hipped roof, spindle frieze, turned posts with small brackets and balustrade.

10. Bibliography and/or references (such as local histories, deeds, assessor's records, early maps, etc.)

1884 & 1895 Atlases
 Registry of Deeds: Bk.442-P.131