

FORM B - BUILDING

MASSACHUSETTS HISTORICAL COMMISSION
Office of the Secretary, State House, Boston

640

| | |
|-------------|----------|
| In Area no. | Form no. |
| | 31B-155 |



Northampton

11 Trumbull Rd.

J. Gagne House

residence

Edward and Josephine

Cavallari

1895-1915

Atlases

in relation to nearest cross streets and other buildings. Indicate north.

Architect

Exterior wall fabric clapboard

Outbuildings (describe)

Other features

Altered -- Date

Moved -- Date

5. Lot size:

One acre or less x Over one acre

Approximate frontage

Approximate distance of building from street

6. Recorded by E. Lonergan

Organization NHC

Date May 1980

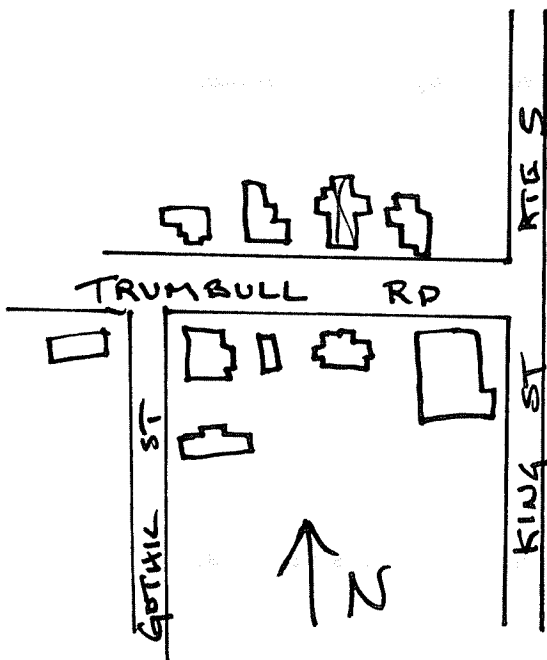

(over)

7. Original owner (if known) Joseph Gagne
 Original use residence
 Subsequent uses (if any) and dates _____

8. Themes (check as many as applicable)

| | | | | | |
|-----------------------|----------|----------------------------|-------|-------------------------|-------|
| Aboriginal | _____ | Conservation | _____ | Recreation | _____ |
| Agricultural | _____ | Education | _____ | Religion | _____ |
| Architectural | <u>x</u> | Exploration/ settlement | _____ | Science/ invention | _____ |
| The Arts | _____ | Industry | _____ | Social/ humanitarian | _____ |
| Commerce | _____ | Military | _____ | Transportation | _____ |
| Communication | _____ | Political | _____ | | |
| Community development | <u>x</u> | | | | |

9. Historical significance (include explanation of themes checked above)

The northern corner of Park (now Trumbull Rd.) and King Sts. remained undeveloped until the turn of the 20th century. King St. Brook, which began between Round Hill and Childs Park ran through here, and probably made the surrounding land too swampy for buildings. During the latter part of the 19th century the brook was put underground, enabling the land to be residentially developed.

This house is two-and-a-half stories in height with gable end to the street. The gable is pedimented and contains a double sash window within. A one-story porch with gabled entrance extends across the two bay facade. The porch has square posts, a balustrade and square newel posts.

The original owner appears to have been Joseph Gagne, a Pleasant St. liquor dealer.

10. Bibliography and/or references (such as local histories, deeds, assessor's records, early maps, etc.)

*1895 and 1915 Atlases.
 Northampton Directory: 1905, 1915 and 1922.*