

Benjamin B. Hinckley

7. Original owner (if known) \_\_\_\_\_

Original use \_\_\_\_\_ residence \_\_\_\_\_

Subsequent uses (if any) and dates \_\_\_\_\_

8. Themes (check as many as applicable)

Aboriginal	_____	Conservation	_____	Recreation	_____
Agricultural	_____	Education	_____	Religion	_____
Architectural	x	Exploration/ settlement	_____	Science/ invention	_____
The Arts	_____	Industry	_____	Social/ humanitarian	_____
Commerce	_____	Military	_____	Transportation	_____
Communication	_____	Political	_____		
Community development	_____				

9. Historical significance (include explanation of themes checked above)

Barrett Place was laid out in 1910 through a portion of the H.R. Hinckley estate on Prospect St. (known as the Manse). Benjamin Barrett Hinckley was a son of H.R. Hinckley and had this house built by 1915 when it appears on the atlas. Benjamin was clerk of the Northampton Cutlery Co. and later became manager of the International Silver Co. in Florence.

The house is two stories tall with slate gambrel roof, two interior chimneys and three shed roof dormers. The symmetrical five-bay facade has a central entrance with sidelights and a gabled portico with front arched opening, festooned frieze and doubled Doric columns. The windows have heavy cornices and nine over one sashes. On either end of the house are one-story porches topped by balconies.

10. Bibliography and/or references (such as local histories, deeds, assessor's records, early maps, etc.)

1895 and 1915 Atlases.  
Northampton Directory: 1905, 1915, 1922 and 1930.

FORM B - BUILDING

MASSACHUSETTS HISTORICAL COMMISSION  
Office of the Secretary, State House, Boston

In Area no.	Form no.
	31B-172

654



Northampton

Address 32 Barrett Pl.

Name B. Hinckley House

Present use residence

Present owner Robert and Sarah Bagg

Description: 1905-15

Source Directory and Atlas

4. Map. Draw sketch of building location in relation to nearest cross streets and other buildings. Indicate north.

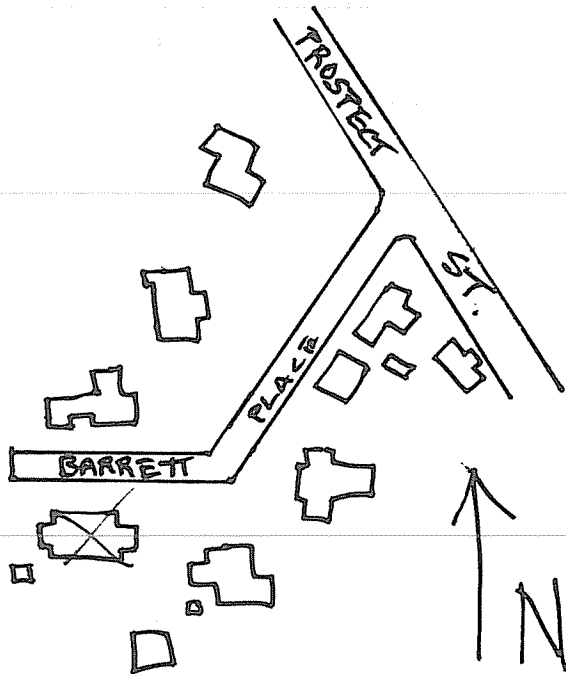

Architect \_\_\_\_\_

Exterior wall fabric clapboard

Outbuildings (describe) \_\_\_\_\_

Other features Gambrel roof with 2 tall interior chimneys, open pedimented portico, side balconied porch.

Altered -- Date \_\_\_\_\_

Moved -- Date \_\_\_\_\_

5. Lot size:

One acre or less x Over one acre \_\_\_\_\_

Approximate frontage \_\_\_\_\_

Approximate distance of building from street \_\_\_\_\_

6. Recorded by E. Lonergan

Organization NHC

Date March 1980

(over)