

FORM B - BUILDING

MASSACHUSETTS HISTORICAL COMMISSION
Office of the Secretary, State House, Boston

In Area no.	Form no.
	31B-219



Northampton

Address 11 Allen Place

Type House

Present use Residence

Present owner Julia Petrovich

Description:

c. 1885
Registry of Deeds; 1884 & 95
Source Atlas of Northampton

Victorian Gothic

Architect unknown

in relation to nearest cross streets and other buildings. Indicate north.

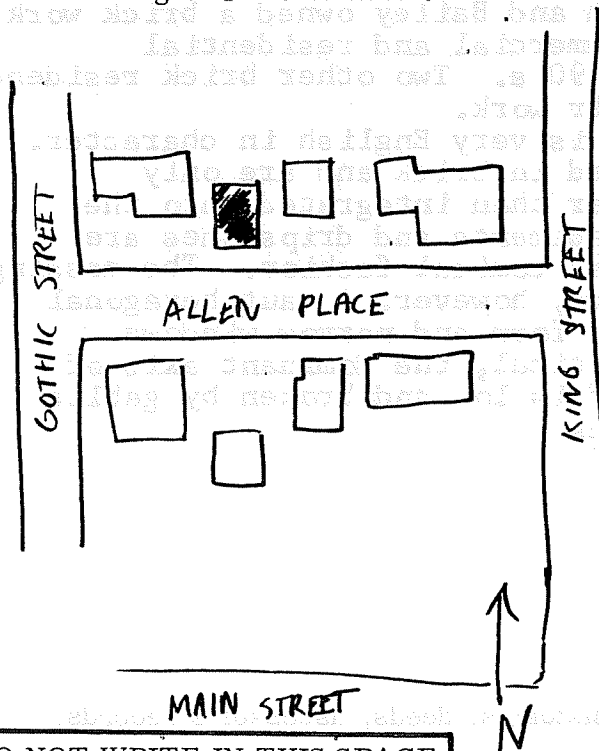

Exterior wall fabric Brick

Outbuildings (describe) none

Other features Window pediments and arches executed exclusively in brick; 2 1/2 stories; porch.

Altered no Date _____

Moved no Date _____

5. Lot size:

One acre or less x Over one acre _____

Approximate frontage 25 feet

Approximate distance of building from street 5 feet

6. Recorded by C. Dubie

Organization Northampton Historical Commission

Date May 1, 1975

DO NOT WRITE IN THIS SPACE

USGS Quadrant _____

MHC Photo no. _____

RECEIVED

AUG 4 1975
MASS HIST. COMM.

7. Original owner (if known) Samuel C Brown

Original use residence

Subsequent uses (if any) and dates residence

8. Themes (check as many as applicable)

- | | | | | | |
|-----------------------|-------------------------------------|----------------------------|--------------------------|-------------------------|--------------------------|
| Aboriginal | <input type="checkbox"/> | Conservation | <input type="checkbox"/> | Recreation | <input type="checkbox"/> |
| Agricultural | <input type="checkbox"/> | Education | <input type="checkbox"/> | Religion | <input type="checkbox"/> |
| Architectural | <input checked="" type="checkbox"/> | Exploration/
settlement | <input type="checkbox"/> | Science/
invention | <input type="checkbox"/> |
| The Arts | <input type="checkbox"/> | Industry | <input type="checkbox"/> | Social/
humanitarian | <input type="checkbox"/> |
| Commerce | <input type="checkbox"/> | Military | <input type="checkbox"/> | Transportation | <input type="checkbox"/> |
| Communication | <input type="checkbox"/> | Political | <input type="checkbox"/> | | |
| Community development | <input type="checkbox"/> | | | | |

9. Historical significance (include explanation of themes checked above)

One of two Gothic brick residences on Allen Place, this two story house was built about 1885 for Samuel C. Brown. The residence facing the 1885 house was built about 1883 by William Bailey and Jeremiah Brown and sold to Samuel Brown in 1897. Brown and Bailey owned a brick works which supplied brick for commercial and residential buildings in the 1880's and 90's. Two other brick residences on Allen Place are also their work. The house at 11 Allen Place is very English in character. Window pediments are executed in brick and are only attached to the facade rather than integrated into the plane of the brick wall. Pediments and dripstones are reproduced in a blunt, almost comical fashion. The massing of the structure is effective, however. A taut hexagonal bay modifies the rectangular form and narrow windows in the bay emphasize the vertical, the dominant axis of the Gothic. The hipped roof is low and broken by gables in the south and west facades.

10. Bibliography and/or references (such as local histories, deeds, assessor's records, early maps, etc.)

Registry of Deeds, Hampshire County: 965.291, 963.508, 852.391, 786.428, 786/433-4, 323.277, 292.171, 212.243.

Walker's 1884 Atlas of Northampton; 1895 Atlas of Northampton.