

FORM B - BUILDING

MASSACHUSETTS HISTORICAL COMMISSION
Office of the Secretary, State House, Boston

In Area no.	Form no.
	31 B 253

711



1. Town Northampton
 Address Bedford Terrace, Smith campus
 Name Baldwin House
 Present use college dormitory
 Present owner Smith College

3. Description:
 Date 1908
 Source Smith College Archives
 Style Neo-Georgian
 Architect Charles A. Rich, of N.Y.C.
 Exterior wall fabric brick
 Outbuildings (describe) none
 Other features three stories; white classical detailing; pitched roof

Altered no Date _____
 Moved no Date _____

5. Lot size:
 One acre or less _____ Over one acre _____
 Approximate frontage _____
 Approximate distance of building from street _____

6. Recorded by Ann Gilkerson
 Organization Northampton Historical Commission
 Date March 26, 1977

7. Map. Draw sketch of building location in relation to nearest cross streets and other buildings. Indicate north.

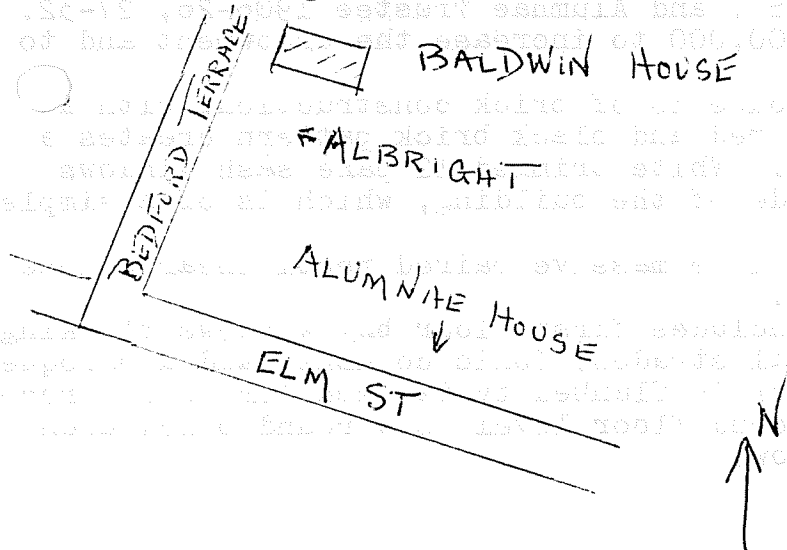

DO NOT WRITE IN THIS SPACE
USGS Quadrant _____
MHC Photo no. _____

(over)

7. Original owner (if known) Smith College

Original use same as present

Subsequent uses (if any) and dates _____

8. Themes (check as many as applicable)

Aboriginal	_____	Conservation	_____	Recreation	_____
Agricultural	_____	Education	<u>x</u>	Religion	_____
Architectural	<u>x</u>	Exploration/ settlement	_____	Science/ invention	_____
The Arts	_____	Industry	_____	Social/ humanitarian	_____
Commerce	_____	Military	_____	Transportation	_____
Communication	_____	Political	_____		
Community development	_____				

9. Historical significance (include explanation of themes checked above)

Opened in 1908, Baldwin House was named for William H. Baldwin Jr., Harvard 1885, President of the Long Island Railroad Company 1896-1905, Trustee of Smith 1898-1905, and a public spirited philanthropist and civic reformer. His wife was Ruth Standish Bowles Baldwin, B.A. Smith (1887), Secretary to President Seelye 1888-89, and Alumnae Trustee 1906-26, 27-32. Mr. Baldwin's influence provided \$200,000 to increase the endowment and to build John M. Greene Hall.

This Neo-Georgian four story house is of brick construction, with a pitched roof. The alternating dark red and black brick pattern creates a subtle checkerboard surface pattern. White trimmed 12 pane sash windows are regularly spaced along the facade of the building, which is of a simple "L" shaped plan.

Other Neo-Georgian features include massive paired rectilinear chimneys and blank fanlit pedimented dormers.

The formally arranged facade includes first floor bay windows flanking the classically detailed porch of balustrades, Ionic columns, and a baroque undulating pediment. The fanlit door is flanked by two smaller round arched windows. Above the porch at the second floor level is a round brick arch with an inset, white shuttered window.

10. Bibliography and/or references (such as local histories, deeds, assessor's records, early maps, etc.)
 Smith College Archives