

FORM B - BUILDING

MASSACHUSETTS HISTORICAL COMMISSION  
Office of the Secretary, State House, Boston

ENDANGERED NR accepted 4/30/76

In Area no. C	Form no. 31D-17
------------------	--------------------

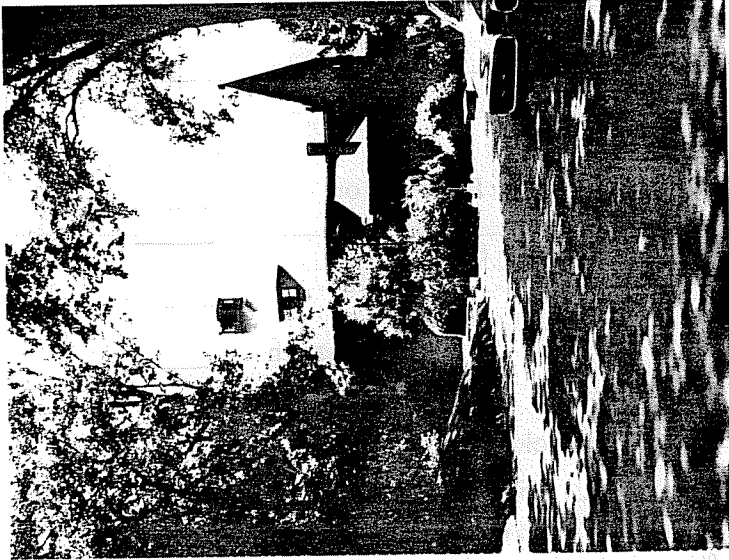

1. Town Northampton 743  
 Address Smith College  
 Name Alumnæ Gymnasium  
 Present use gymnasium  
 Present owner Smith College

3. Description:  
 Date 1890-95  
 Source Archives at Smith  
 Style Victorian Gothic w/ Queen Anne elements  
 Architect Peabody & Stearns of Boston  
 Exterior wall fabric red brick  
 Outbuildings (describe) none  
 Other features crisp-looking slate roof planes, int. raised running track, int. sheathed in wood, etc. (See back)  
 Altered Squash courts addition Date unknown as yet  
 Moved -no- Date —

4. Map. Draw sketch of building location in relation to nearest cross streets and other buildings. Indicate north.

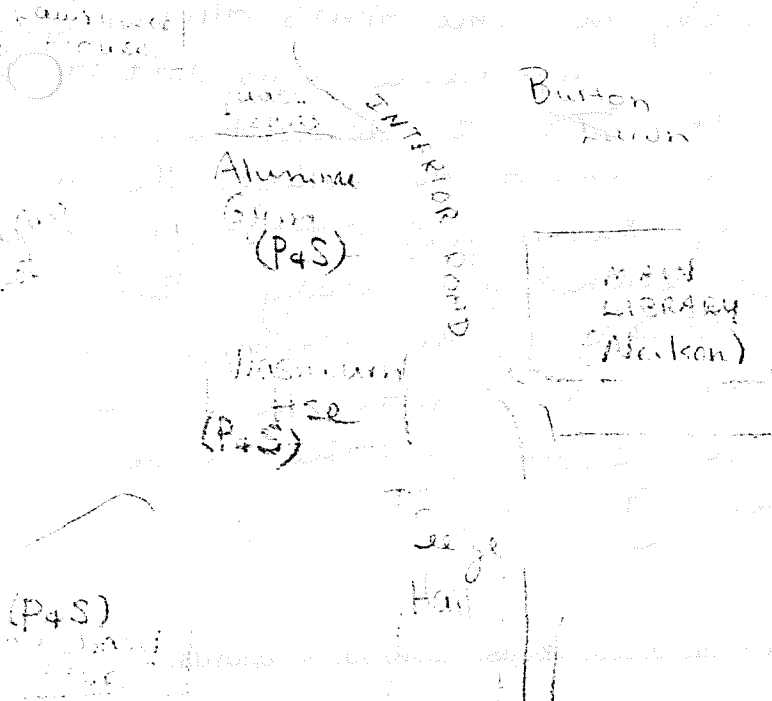

5. Lot size:  
 One acre or less  Over one acre   
 Approximate frontage —  
 Approximate distance of building from street located inside college campus

DO NOT WRITE IN THIS SPACE  
 USGS Quadrant \_\_\_\_\_  
 MHC Photo no. \_\_\_\_\_

RECEIVED  
 JUL 18 1975  
 Recorded by Ms. Janet C. Smith  
 Organization Committee to Preserve Alumnæ Gym  
 Date 27 June 1975

MASS. HIST. COMM. (over)

College Hall (P+S)  
Stearns = (P+S)

7. Original owner (if known) Smith College  
 Original use gymnasium  
 Subsequent uses (if any) and dates theater

8. Themes (check as many as applicable)

Aboriginal	_____	Conservation	_____	Recreation	_____
Agricultural	_____	Education	<u>X</u>	Religion	_____
Architectural	<u>X</u>	Exploration/ settlement	_____	Science/ invention	_____
The Arts	_____	Industry	_____	Social/ humanitarian	_____
Commerce	_____	Military	_____	Transportation	_____
Communication	_____	Political	_____		
Community development	_____				

9. Historical significance (include explanation of themes checked above)

Peabody + Stearns of Boston were the first official architects of Smith College. They built College Hall (1874), Gateway Hse (1874), Hatfield Hse (1876), Washburn Hse (1878), Hubbard Hse (1879), Old Hillier Hall (1881), Pierce Hall (1882), as well as the original wooden gym (1879) later replaced by the same firm's Alumnae Gym in 1890. The Alumnae Gym's major importance is as part of this initial bldg. campaign at Smith. ~~Its~~ Its demolition would drastically disrupt the original plans of the college. To my knowledge, Smith is the only educational institution whose first major bldgs. were all designed by Peabody + Stearns, thus planning & bldg. relationships are as important as the bldgs. themselves. The historical significance of Peabody + Stearns' only known college campus seems self-evident and well worth preserving.

10. Bibliography and/or references (such as local histories, deeds, assessor's records, early maps, etc.)

Smith College Archives.  
 "The Peabody Touch: Peabody + Stearns of Boston, 1870-1917,"  
 by Wheaton Holden in Journal of the Society of  
 Architectural Historians, May 1973, pp 114ff.