

MISSION
oston

In Area no. <u>A</u>	Form no. <u>31D-139</u> <u>+ 140</u>
-------------------------	--

1. Town Northampton
 Address 183-187 Main
189-191 Main
 Name Fleming Block
Astman Block
 Present use Commercial

Present owner 183-187-Ernest Richardson
189 & 191-Alexander August

3. Description:
1868-Astman Block
 Date 1871- Fleming Block
8/11/68, 4/18/1871
 Source Daily Hampshire Gazette

Style Victorian Commercial
1868 building-unknown
 Architect 1871 building- J. M. Miner

Exterior wall fabric brick
 Outbuildings (describe) none
 Other features brickwork cornice,
brownstone window surrounds,

Altered no Date _____
 Moved no Date _____

5. Lot size:
 One acre or less x Over one acre _____
 Approximate frontage 25 feet each
 Approximate distance of building from street
five feet

6. Recorded by C. Dubie
 Organization Northampton Historical
 Commission
 Date April 15, 1975

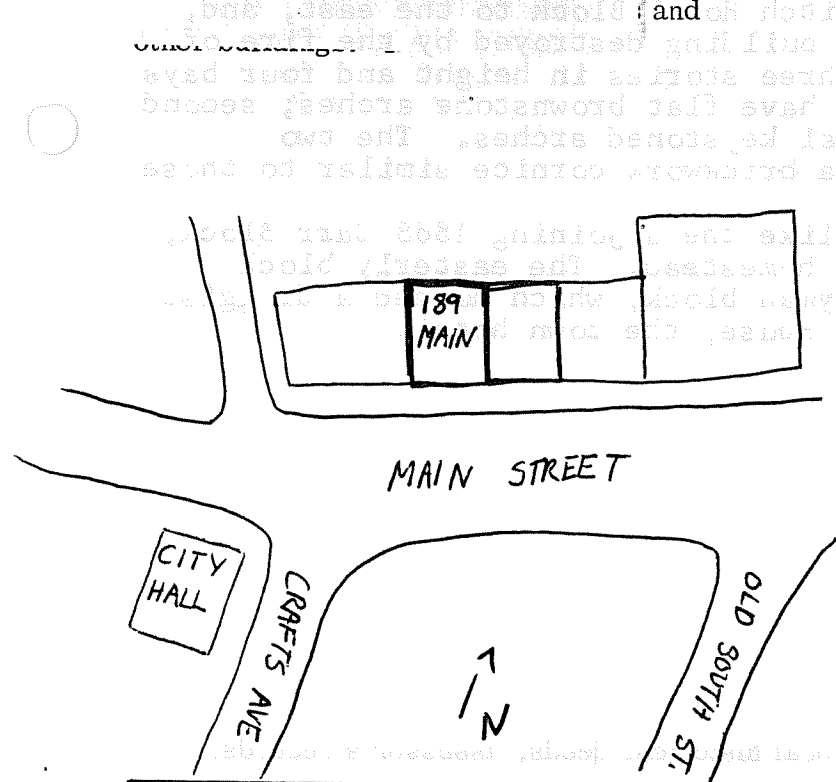

DO NOT WRITE IN THIS SPACE
 USGS Quadrant _____
 MHC Photo no. _____

RECEIVED

MAY 2 1975
 (over)
 MASS. HIST. COMM.

7. Original owner (if known) 1868 building-
1871 building-Williams Block

Original use commercial

Subsequent uses (if any) and dates commercial

8. Themes (check as many as applicable)

Aboriginal	<u> </u>	Conservation	<u> </u>	Recreation	<u> </u>
Agricultural	<u> </u>	Education	<u> </u>	Religion	<u> </u>
Architectural	<u> x </u>	Exploration/ settlement	<u> </u>	Science/ invention	<u> </u>
The Arts	<u> </u>	Industry	<u> </u>	Social/ humanitarian	<u> </u>
Commerce	<u> </u>	Military	<u> </u>	Transportation	<u> </u>
Communication	<u> </u>	Political	<u> </u>		
Community development	<u> x </u>				

9. Historical significance (include explanation of themes checked above)

These two virtually identical commercial blocks were built in 1868 and 1871, during the period of expansion of the business community in Northampton. The Williams Block (easterly) abuts the Old Fitch Hotel Block to the east, and, like the hotel, replaced a building destroyed by the fire of 1870. The buildings are three stories in height and four bays wide. First story windows have flat brownstone arches; second story windows have segmental keystone arches. The two buildings are capped with a brickwork cornice similar to those on other downtown blocks.

The westerly block, like the adjoining 1868 Carr Block, was built on the old Lyman homestead. The easterly block was once the site of the Lyman block, which housed a druggist and abutted the old Warner House, the town hotel.

10. Bibliography and/or references (such as local histories, deeds, assessor's records, early maps, etc.) Daily Hampshire Gazette, August 11, 1868, April 18, 1871.