

874

FORM B - BUILDING

MASSACHUSETTS HISTORICAL COMMISSION
Office of the Secretary, State House, Boston

In Area no. <u>B</u>	Form no. <u>32A-180</u>
-------------------------	----------------------------



Town Northampton, Mass. 01060

Address 96 Bridge Street

Name Wright Home

Present use Half-way house, Belchertown,
Munson State Schools

Present owner Paul Stramese - Charles Lyons

Description:

Date 1684

Source Daily Hampshire Gazette Oct. 18, 1920

Style 17th Century

Architect unknown

Exterior wall fabric Gray Clapboard

Outbuildings (describe) Small Barn

Other features Ridge roof; low foundation; 2 end
chimneys; regular double hung windows front;
irregularly placed sides and wing; two side
porches; front central entrance; side entrance on
wing; recessed balcony over front entrance
portico; center chimney on back wing.

Altered various Date _____
additions

Moved no Date _____

5. Lot size:

One acre or less _____ Over one acre X

Approximate frontage 400'

Approximate distance of building from street
2'

6. Recorded by Emmy C. Clausing

Organization Northampton Historical Commission

Date October 1, 1974

4. Map. Draw sketch of building location
in relation to nearest cross streets and
other buildings. Indicate north.

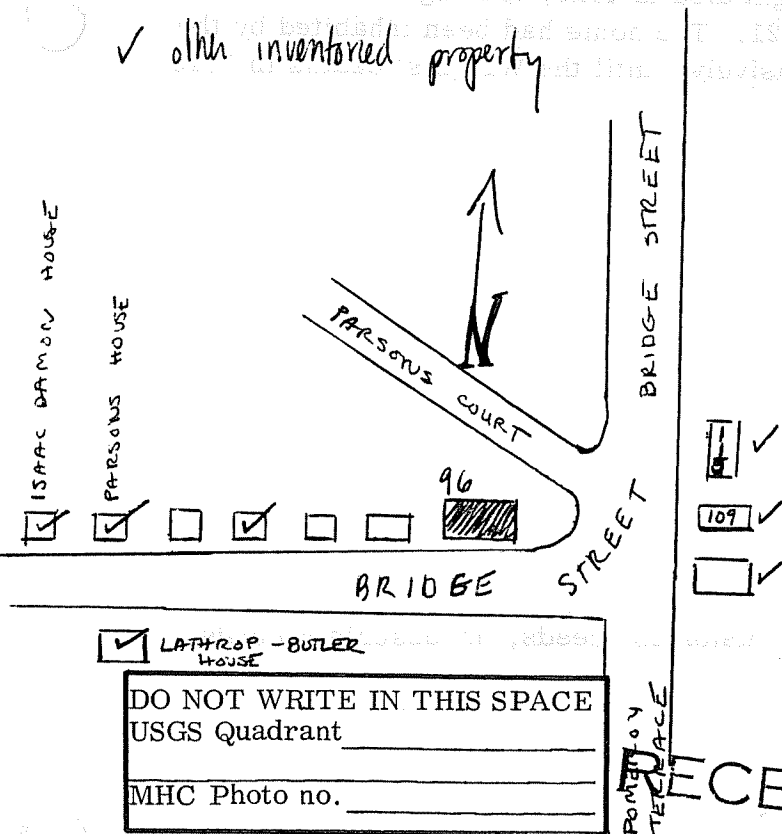

7. Original owner (if known) Ebenezer Wright

Original use Residence

Subsequent uses (if any) and dates Wright School for Young Women - 1921

8. Themes (check as many as applicable)

- | | | | | | |
|-----------------------|---------------|----------------------------|---------------|-------------------------|---------------|
| Aboriginal | <u> </u> | Conservation | <u> </u> | Recreation | <u> </u> |
| Agricultural | <u> </u> | Education | <u> X </u> | Religion | <u> </u> |
| Architectural | <u> </u> | Exploration/
settlement | <u> </u> | Science/
invention | <u> </u> |
| The Arts | <u> </u> | Industry | <u> </u> | Social/
humanitarian | <u> </u> |
| Commerce | <u> </u> | Military | <u> </u> | Transportation | <u> </u> |
| Communication | <u> </u> | Political | <u> </u> | | |
| Community development | <u> X </u> | | | | |

9. Historical significance (include explanation of themes checked above)

The original Wright Homestead was said to stand on the present location, built by Ebenezer Wright about 1684. It is possible that the rear wing of the house with the central fireplace was the original structure, with the front added later.

The present owners bought the property from the Estate of Margaret P. and Henrietta M. Wright in 1970; the Misses Wright died in 1918, leaving their home for the Wright Home for Young Women, opened in 1921. The home had been inhabited by the Wright Family for several generations, exclusively, until the Wrights' deaths in 1918.

10. Bibliography and/or references (such as local histories, deeds, assessor's records, early maps, etc.)

- Assessor's Book #1582, P. 354
- Daily Hampshire Gazette October 18, 1920
- April 18, 1918
- April 25, 1918
- April 30, 1918
- May 3, 1918
- June 4, 1920
- February 5, 1921
- February 11, 1921