

FORM B - BUILDING

MASSACHUSETTS HISTORICAL COMMISSION
Office of the Secretary, State House, Boston

In Area no.	Form no.
	32A-217

Town Northampton

Address 14 Hancock St.

Name J.M. Clark House

Present use residence

Present owner Claire Doyle et al.

Description: 1873-75

Source Atlas and Directory

Architect _____

Exterior wall fabric clapboard

Outbuildings (describe) _____

Other features _____

Altered side porch added Date 20th c.

Moved -- Date _____

5. Lot size:

One acre or less x Over one acre _____

Approximate frontage _____

Approximate distance of building from street

15'

6. Recorded by E. Lonergan

Organization NHC

Date April 1980

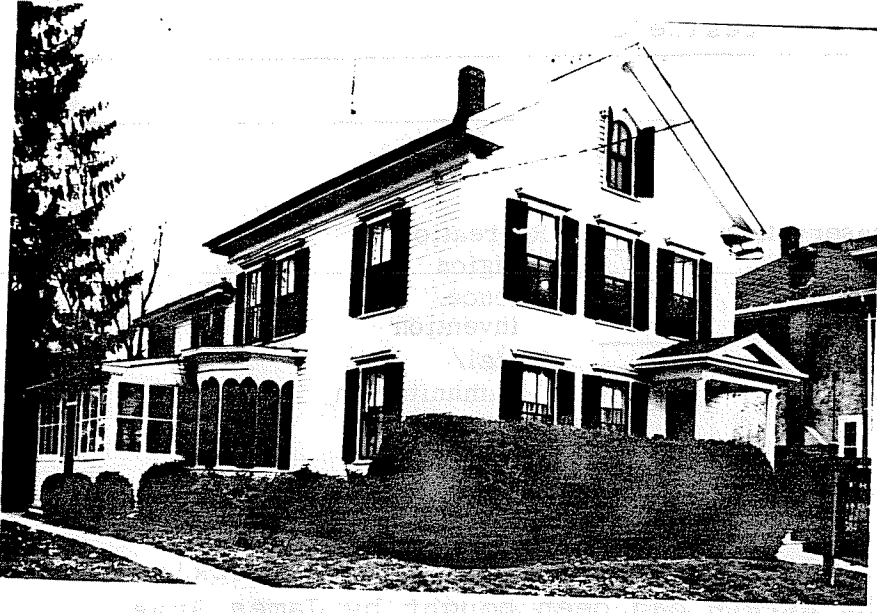

4. Map. Draw sketch of building in relation to nearest cross streets and other buildings. Indicate north.

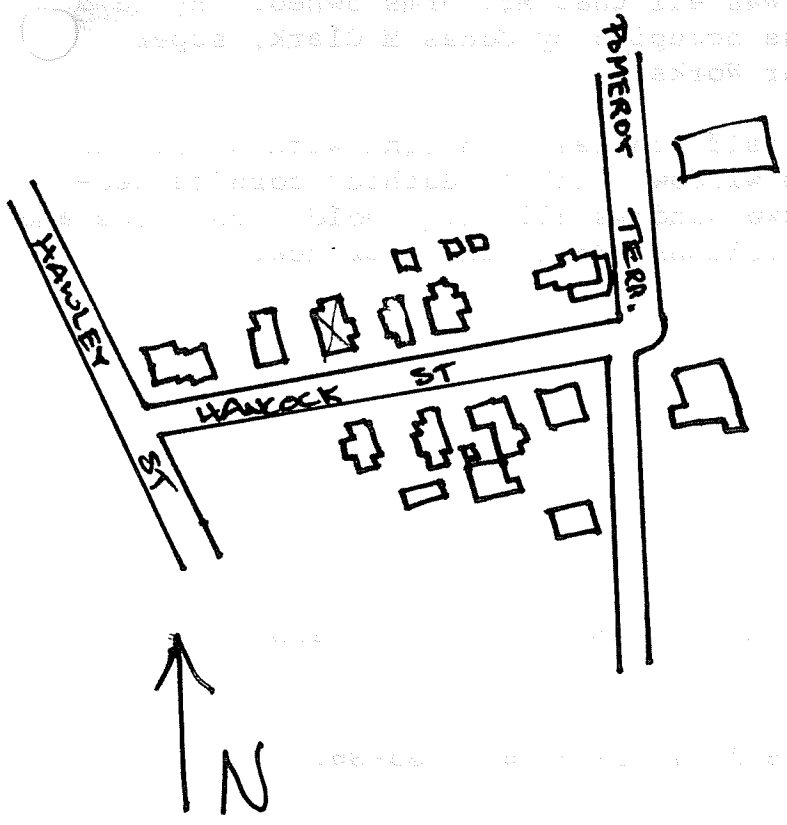

(over)

7. Original owner (if known) Jonas M. Clark
 Original use residence
 Subsequent uses (if any) and dates _____

8. Themes (check as many as applicable)

Aboriginal	_____	Conservation	_____	Recreation	_____
Agricultural	_____	Education	_____	Religion	_____
Architectural	<u>x</u>	Exploration/ settlement	_____	Science/ invention	_____
The Arts	_____	Industry	_____	Social/ humanitarian	_____
Commerce	_____	Military	_____	Transportation	_____
Communication	_____	Political	_____		
Community development	<u>x</u>				

9. Historical significance (include explanation of themes checked above)

Hancock St. was opened in 1873 across Ebenezer Hancock's former Hawley St. estate. The estate had been bought by James Arms, a co-owner of the Arms and Bardwell Manufacturing Co., which was located on the west side of Hawley St. near Holyoke St. and produced hoop skirts, pocketbooks and diaries. Lots were only available on the north side of the street as that was all that Mr. Arms owned. By 1875 this house had been built, and was occupied by Jonas M Clark, superintendent of the Northampton Water Works:

The house is two and a half stories in height with gable end to the street. A rounheaded sash window with a "Gothic" cornice decorates the gable. The two over two windows all have molded cornices and a pedimented portico with Tuscan columns adorns the entrance.

10. Bibliography and/or references (such as local histories, deeds, assessor's records, early maps, etc.)

1873, 1884 and 1895 Atlases.
 Northampton Directory: 1868-69, 1873-74, 1875-76, 1885-86.
 Registry of Deeds: Bk. 306_P. 111.