

FORM B - BUILDING

MASSACHUSETTS HISTORICAL COMMISSION
Office of the Secretary, State House, Boston

In Area no. <u>B</u>	Form no. <u>32A-227</u>
-------------------------	----------------------------

907

1. Town Northampton

Address 58 Pomeroy Terrace

William Gaylord House

Present use College Church, Inc.

Present owner The College Church, Inc.

Description:

1849-1850

Source Registry of Deeds,
Daily Hampshire Gazette

Swiss Cottage

Architect Wm. Fenno Pratt

Exterior wall fabric wood



Outbuildings (describe) large structure rear

Other features board & batten siding;

brackets and vergeboard trim; 2 small balconies; ornate chimneys.

Altered no Date _____

Moved no Date _____

5. Lot size:

One acre or less _____ Over one acre x

Approximate frontage 185 feet

Approximate distance of building from street

10 feet

6. Recorded by C. Dubie

Organization Northampton Historical Commission

Date May 15, 1975

Other inventoried property

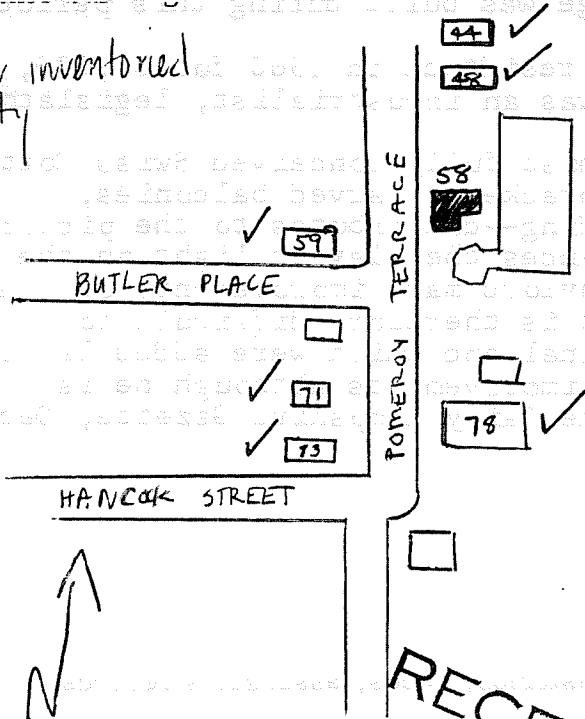

DO NOT WRITE IN THIS SPACE
USGS Quadrant _____
MHC Photo no. _____

RECEIVED

AUG 4 1975
MASS. HIST. COMM.
(over)

7. Original owner (if known) Thomas R. Green

Original use Residence

Subsequent uses (if any) and dates Residence; Northampton School for Girls, 1960-

8. Themes (check as many as applicable) 1974

Aboriginal	<input type="checkbox"/>	Conservation	<input type="checkbox"/>	Recreation	<input type="checkbox"/>
Agricultural	<input type="checkbox"/>	Education	<input type="checkbox"/>	Religion	<input type="checkbox"/>
Architectural	<input checked="" type="checkbox"/>	Exploration/ settlement	<input type="checkbox"/>	Science/ invention	<input type="checkbox"/>
The Arts	<input type="checkbox"/>	Industry	<input type="checkbox"/>	Social/ humanitarian	<input type="checkbox"/>
Commerce	<input type="checkbox"/>	Military	<input type="checkbox"/>	Transportation	<input type="checkbox"/>
Communication	<input type="checkbox"/>	Political	<input type="checkbox"/>		
Community development	<input type="checkbox"/>				

9. Historical significance (include explanation of themes checked above)

This Swiss Cottage on Pomeroy Terrace was designed by Wm. F. Pratt, local architect, and built between 1849 and 1853, probably in 1850. Thomas Green, the original owner, bought the principal parcels of land from J. H. Butler and H. Clarke in 1849; his homestead was built by 1853, at which time he acquired additional sections of land from various individuals. A second Swiss Cottage was built during this period on Phillips Place.

William Gaylord purchased the residence in 1860 for \$8,000, and made improvements on it. Gaylord was an industrialist, legislator, and trustee of the State Hospital.

The two story cottage is the most fully conceived Swiss Cottage in Northampton. Each detail—airy brackets, carved balconies, closely spaced board and batten siding—contributes to the picturesque composition and encourages and enhances the play of light on the facades. As has been mentioned, Gaylord made improvements on the cottage soon after its purchase; it is therefore difficult to determine which features were original and which were added later. Pratt is nowhere credited with the improvements although he is credited with "Mr. Gaylord's" in the Daily Hampshire Gazette, December 26, 1865.

10. Bibliography and/or references (such as local histories, deeds, assessor's records, early maps, etc.)

- Atlas of Northampton, 1873, 1884.
- Registry of Deeds, Hampshire County, 197.309 (Gaylord from Green), 128.208, 129.104, 129.105, 151.255, 152.526, 153.414.
- Daily Hampshire Gazette, November 30, 1860, December 26, 1865.

RELATION OF SURROUNDING TO STRUCTURE

907 - -

1. Outbuildings _____

Landscape Features: Agriculture Open Wooded Garden: Formal/Informal
Predominant features large trees - view
Landscape architect _____

3. Neighboring Structures

Style: Colonial Federal Greek Revival Gothic Revival Italian Villa Lombard Rom.
Venetian Gothic Mansard Richardsonian Modern

Use: Residential Commercial Religious Conditions: Excellent Good Fair Deteriorated

GIVE A BRIEF DESCRIPTION OF HISTORIC IMPORTANCE OF SITE (Refer and elaborate on theme circled on front of form)

William M. Gaylord Homestead - Gaylord was an iron manufacturer. He was born in 1821, was a legislator, trustee of the State Hospital. The house was later the home of Frank Gaylord and John Spencer Bassett. The architectural style derives from several Victorian domestic sources. The gardens were laid out to benefit from the view of the Mount Holyoke range of mountains.

BIBLIOGRAPHY AND/OR REFERENCE

Forbes Library Art Department, Photo Collection 844 N Rn G256 (photo- 1927) and in a photo of Pomeroy Terrace

Northampton Book- p. 151

see Hampshire Gazette December 22, 1885, "Widening Pomeroy Terrace"

RESTRICTIONS _____

Original Owner: William M. Gaylord

Deed Information: Book Number _____ Page _____, _____ Registry of Deeds

