

FORM B - BUILDING

MASSACHUSETTS HISTORICAL COMMISSION
Office of the Secretary, State House, Boston

In Area no.	Form no.
	17C-135

93

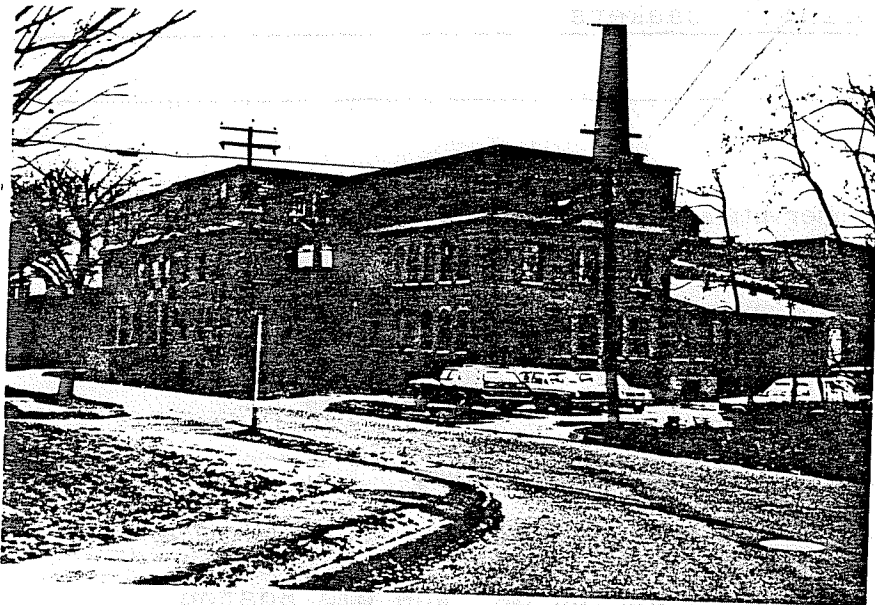

Town Northampton

Address 16 Barwell St.

Owner Florence Furniture Co.

Present use manufacturing

Present owner Florence Casket Co.

Description:

Year 1873

Source

Style Second Empire

Architect

Exterior wall fabric brick

Outbuildings (describe)

Other features

Altered 3rd floor Date early 20th c

Moved -- Date

5. Lot size:

One acre or less Over one acre

Approximate frontage

Approximate distance of building from street

6. Recorded by E. Lonergan

Organization NHC

Date June 1980

Map. Show building on map in relation to nearest cross streets and other buildings. Indicate north.

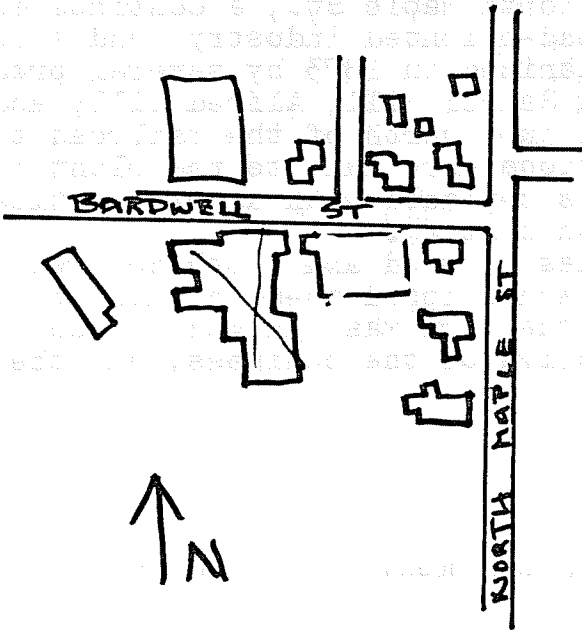

(over)

7. Original owner (if known) Florence Furniture Co.

Original use manufacturing of caskets

Subsequent uses (if any) and dates _____

8. Themes (check as many as applicable)

Aboriginal	_____	Conservation	_____	Recreation	_____
Agricultural	_____	Education	_____	Religion	_____
Architectural	_____	Exploration/ settlement	_____	Science/ invention	_____
The Arts	_____	Industry	<u> x </u>	Social/ humanitarian	_____
Commerce	_____	Military	_____	Transportation	_____
Communication	_____	Political	_____		
Community development	<u> x </u>				

9. Historical significance (include explanation of themes checked above)

The 1860 map of Florence depicts a village located on a bend in the Mill Rvier and extending northwards up the terrace and along the plateau to Main St., which had served as the old Boston and Albany stage route. At that time there was no development between Main St. and Bridge Rd. The establishment of the Williamsburg division if the New Haven and Northampton Railroad in 1867 changed that. The line connected the mill villages of Williamsburg and Northampton (including Florence) to the main north-south line which ran through the center of Northampton. In Florence the tracks ran parallel to, and just north of Main and North Main Sts. North Maple St., a continuation of Maple St. became the locus for railroad-oriented industry and a depot.

The Florence Furniture Co. was organized in 1873 by several prominent Florence industrialists, including Samuel Hill, Alfred Lilly and Geroge Burr, and a brick factory erected just north of the railroad tracks on Myrtle St. (now Bardwell St.). Additions were made to the plant in 1880 and 1888, while the Mansard roof was replaced with a more vertical, tin-covered third floor early in the 20th century.

The Company manufactured "all grades of wood and cloth covered burial cases and undertakers' supplies" and shipped them throughout New England. During the 1920's the name of the firm was changed to the Florence Casket Co., a name more descriptive of the business, and the business continues to this day.

10. Bibliography and/or references (such as local histories, deeds, assessor's records, early maps, etc.)

1860 County Map. 1873, 1884 and 1895 Atlases.
 Northampton Directory: 1965, 1930, 1922.
History of Florence, ed. by Charles A. Sheffield (1895) pp. 239-40.
 "A Chronicle of Industry on the Mill River" Smith College Studies in History, vol 21, Agnes Hollay, 1935-36.