

FORM B - BUILDING

In Area no.	Form no.
	32C-116

MASSACHUSETTS HISTORICAL COMMISSION
Office of the Secretary, State House, Boston



4. Map. Draw sketch or plan in relation to nearest cross streets and other buildings. Indicate north.

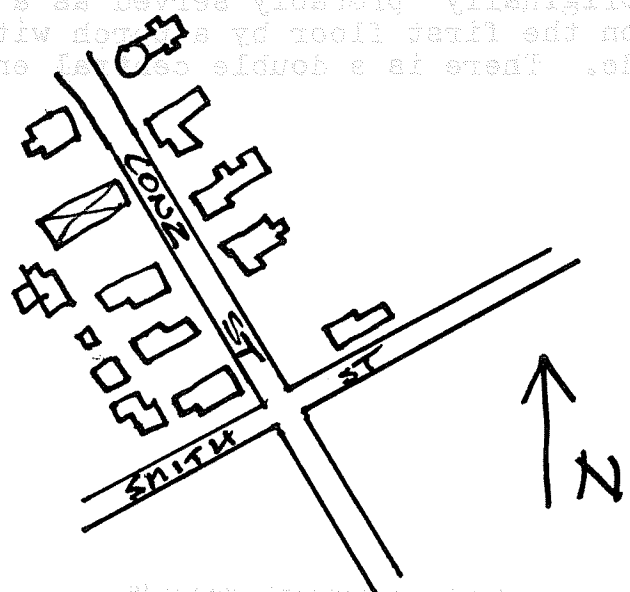

Northampton

Address 33-35 Conz St.

Present use residence

Present owner Daniel and Shirley Levin

Description:

1830-31

Source Reg. of deeds and Map

Architect Daniel Willcut-mason

Exterior wall fabric brick

Outbuildings (describe) _____

Other features pedimented gable with triangular inset

Altered _____ Date _____

Moved -- Date _____

5. Lot size:

One acre or less _____ Over one acre _____

Approximate frontage _____

Approximate distance of building from street _____

6. Recorded by E. Lonergan

Organization NHC

Date Jan. 1980

(over)

7. Original owner (if known) Daniel Willcut

Original use residence

Subsequent uses (if any) and dates _____

8. Themes (check as many as applicable)

Aboriginal	_____	Conservation	_____	Recreation	_____
Agricultural	_____	Education	_____	Religion	_____
Architectural	<u>x</u>	Exploration/ settlement	_____	Science/ invention	_____
The Arts	_____	Industry	_____	Social/ humanitarian	_____
Commerce	_____	Military	_____	Transportation	_____
Communication	_____	Political	_____		
Community development	_____				

9. Historical significance (include explanation of themes checked above)

This double house was built in the early 1830's by Daniel Willcut. Willcut had obtained 1/3 of an acre from Justice Parsons in 1830 for \$433.33. and the house seems to appear on the 1831 map.

Mr. Willcut was a prominent local mason of the mid 19th century. He had learned his trade with Seth Strong, the town's master mason and builder of the "Round House" on this street.

The house is two-and-a-half stories in height with pedimented gable to the street. The tympanum has a large, triangular form, now boarded with a small modern louvered form, which originally probably served as a window. The three-bay facade is covered on the first floor by a porch with hipped roof, chamfered posts and balustrade. There is a double central entrance with transom overhead.

10. Bibliography and/or references (such as local histories, deeds, assessor's records, early maps, etc.)

1831 Town Map. 1854 and 1860 County Map.
1873, 1884 and 1895 Atlases.
Registry of Deeds: Bk. 390-P. 154, 222-155, 222-65, 117-448, 90-125, 79-154 and 63-258.