

FORM B - BUILDING

In Area no.	Form no.
	35-14

MASSACHUSETTS HISTORICAL COMMISSION  
Office of the Secretary, State House, Boston

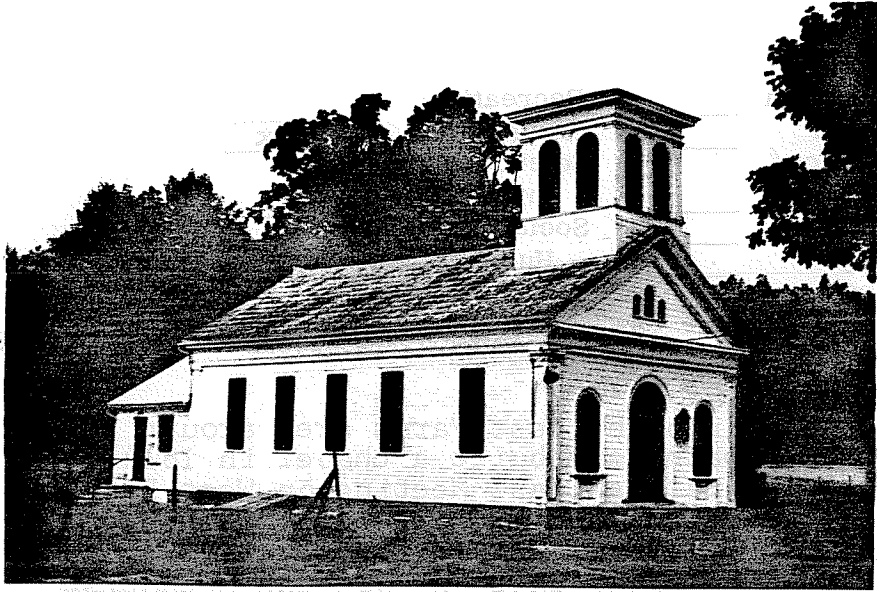

West Farms (Northampton)  
West Farms Road  
West Farms Chapel  
Religious Services

West Farms Congregational  
el Association.  
Description:

1835-present exterior  
visual evidence-see  
reverse for detailed dating

Greek Revival, modified

unknown

wood

none

ridge roof, end chimney;  
single story, balcony in chapel;

remodeled  
later windows  
Altered yes Date 1868

Moved no Date \_\_\_\_\_

5. Lot size:  
Less than one acre x Over one acre \_\_\_\_\_

Approximate frontage 80 feet

Approximate distance of building from street  
20 feet

6. Recorded by C. Dubie

Organization Northampton Historical  
Commission  
Date October, 1975

4. Map. Draw sketch of building location in relation to nearest cross streets and other buildings. Indicate north.

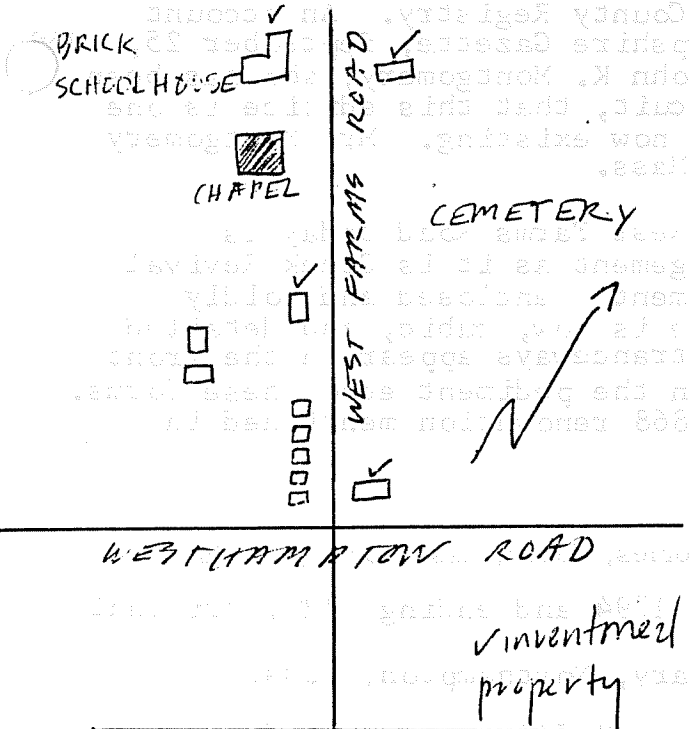

DO NOT WRITE IN THIS SPACE  
 USGS Quadrant \_\_\_\_\_  
 MHC Photo no. \_\_\_\_\_

RECEIVED

FEB 6 1976 (over)

MASS. HIST. CO. 1.

7. Original owner (if known) William Stockwell

Original use chapel

Subsequent uses (if any) and dates chapel

8. Themes (check as many as applicable)

Aboriginal	<input type="checkbox"/>	Conservation	<input type="checkbox"/>	Recreation	<input type="checkbox"/>
Agricultural	<input type="checkbox"/>	Education	<input type="checkbox"/>	Religion	<input checked="" type="checkbox"/>
Architectural	<input type="checkbox"/>	Exploration/ settlement	<input type="checkbox"/>	Science/ invention	<input type="checkbox"/>
The Arts	<input type="checkbox"/>	Industry	<input type="checkbox"/>	Social/ Humanitarian	<input type="checkbox"/>
Commerce	<input type="checkbox"/>	Military	<input type="checkbox"/>	Transportation	<input type="checkbox"/>
Communication	<input type="checkbox"/>	Political	<input type="checkbox"/>		
Community development	<input checked="" type="checkbox"/>				

9. Historical Significance (include explanation of themes checked above)

Methodist missionaries came into the West Farms area around 1800. They worshipped in homes, then in a barn, and built a chapel in 1814. Records of the Granville Circuit indicate a Class Meeting on West Farms Road in 1809. The Rev. Mr. Bigelow holds that the building was built in 1814, enlarged in 1832 and again in 1865. A deed registered in the Hampshire County Registry of Deeds indicates that in 1832 the Methodist Society bought the property--5 rods by 8 rods--and organized a Methodist Society. The chapel was later abandoned by the Methodists though services were held by preachers and in 1868 a West Farms Union Society was organized. In 1914 they bought the Chapel from the Methodists and a deed is registered in Hampshire County Registry. An account of this history was printed in the Hampshire Gazette, September 25, 1950.

It is the opinion of the Rev. John K. Montgomery, who has been writing a history of the Granville Circuit, that this edifice is one of the few edifices of the old Circuit now existing. Mr. Montgomery is retired and living in Northampton, Mass.

The Chapel as one sees it from West Farms Road today is probably the product of the 1832 enlargement as it is Greek Revival in style. Corner pilasters and a pediment enclosed and boldly corniced frame the facade. The steeple is low, cubic, and detailed with small pilasters. Later arched entranceways appear in the front facade and a trio of louvered arches in the pediment echo these forms. These features probably date from an 1868 renovation mentioned in the Gazette.

10. Bibliography and/or references (such as local histories, deeds, assessor's records, early maps, etc.)

Steward's Book beginning 1794 and ending 1823. Original in Boston University Theology Library.

Materials in Forbes Library, Northampton, Mass.

Deed information, 269.71, 698.508, Hampshire County Registry of Deeds.

Hampshire Gazette, July 24, 1864, September 29, 1868.